

Totnes Road, Grimsby, DN33 3DL

Offers In Region Of £220,000

🛏 3 🚿 1 🚿 1



You can also find me on my social media channels:



01472 400 070 - Grimsby & Cleethorpes
01507 307 770 - Louth & Villages



james.stanhope@exp.uk.com



jamesstanhope.exp.uk.com

- Ref No.: JS0755
- Edge of Scartho Village Location
- Living Room & Kitchen/Diner
- Great Potential
- Private Gardens
- Detached Bungalow
- Spacious Accommodation
- Three bedrooms
- Double Length Garage
- No Onward Chain

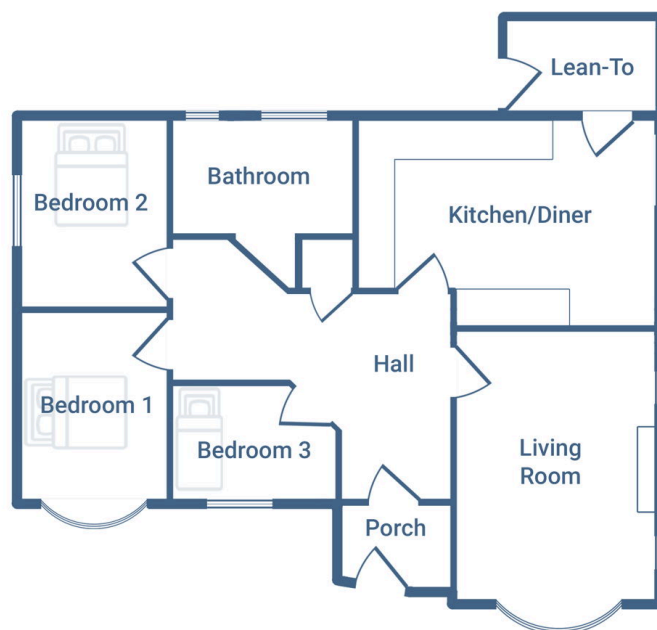

Ground Floor

This floor plan is not drawn to scale. It is for guidance purposes only and should not be relied upon to accurately reflect the property dimensions

NO ONWARD CHAIN - A spacious three bedroom detached bungalow on the edge of Scartho village, bordering Waltham. This bungalow does require modernisation but also has great potential to be a wonderful home to retire to. With a spacious living room and kitchen/diner, three bedrooms and a bathroom. Gardens to either side of the bungalow, parking and a double length garage. Viewing is essential.

You can also find me on my social media channels:



01472 400 070 - Grimsby & Cleethorpes
01507 307 770 - Louth & Villages



james.stanhope@exp.uk.com



jamesstanhope.exp.uk.com