

14, Parkwood Court, Bewdley Road, Kidderminster.

Guide Price £120,000

2 1 1



- Quote Ref. PC0649.
- Popular Location off Bewdley Road
- Quiet Location with Resident Only Parking
- Two Good Sized Bedrooms
- Early Viewing Advised as Likely to Sell Quickly
- Ground Floor Two Bedroom Property in Convenient Location
- Excellent Kitchen/Dining/Lounge
- Excellent Local Amenities with Shops Nearby
- Very Well Presented
- Hit the 'Request Details' or 'Email Agent' button to secure your viewing now!

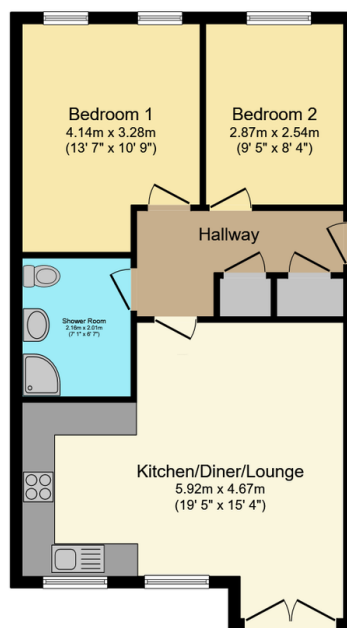

Floor Plan

Floor area 61.6 m² (663 sq.ft.)TOTAL: 61.6 m² (663 sq.ft.)

This floor plan is for illustrative purposes only. It is not drawn to scale. Any measurements, floor areas (including any total floor area), openings and orientations are approximate. No details are guaranteed, they cannot be relied upon for any purpose and do not form any part of any agreement. No liability is taken for any error, omission or misstatement. A party must rely upon its own inspection(s). Powered by www.Propertybox.io

Quote Reference PC0649. Hit 'Request Details'/'Email Agent' to secure a viewing now! A superb modern ground floor apartment with easy access to the town centre and main road networks, situated in this popular development located off Bewdley Road. Briefly comprising of an open plan living dining and kitchen area, two double bedrooms, hallway with storage cupboards and a shower room. Double glazing, electric heating and an allocated parking space. A perfect first

PHIL COOK



@ phil.cook@exp.uk.com

philcook.exp.uk.com

07508 423 891

time purchase or for older buyers requiring single level living. Hit the 'Request Details' or 'Email Agent' button to secure your viewing now!