

## Arundel Road, Wordsley, Stourbridge, DY8 5EJ

Guide Price £280,000

🛏 3 🚿 1 🚿 1



- Quote Reference JS667
- Stylish Refitted Kitchen with Appliances
- 3 Excellent Bedrooms
- Pleasant Landscaped Rear Garden
- Large Extended Lounge with Dining Area
- Superb Extended 3 Bed Semi
- Sumtuous Refitted Bathroom
- Large Hobbies/Games Room
- Wide Block Paved Driveway
- Close to Schools, Shops and Countryside

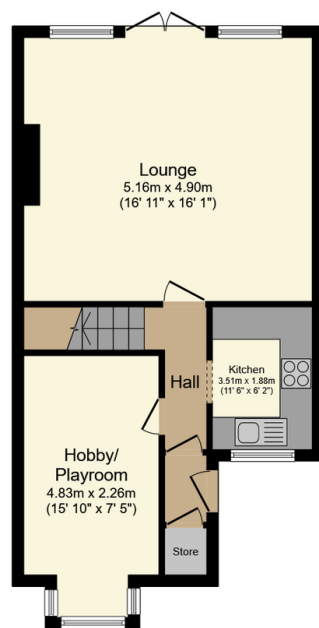

**Ground Floor**

Floor area 50.0 m<sup>2</sup> (538 sq.ft.)

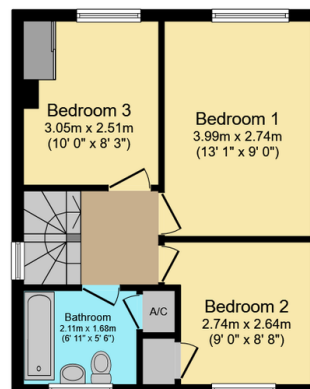

**First Floor**

Floor area 36.2 m<sup>2</sup> (389 sq.ft.)

**TOTAL: 86.1 m<sup>2</sup> (927 sq.ft.)**

This floor plan is for illustrative purposes only. It is not drawn to scale. Any measurements, floor areas (including any total floor area), openings and orientations are approximate. No details are guaranteed, they cannot be relied upon for any purpose and do not form any part of any agreement. No liability is taken for any error, omission or misstatement. A party must rely upon its own inspection(s). Powered by www.Propertybox.io

This beautifully presented, stylishly improved and EXTENDED Modern 3 Bedroom Semi-Detached affords outstanding and generously proportioned accommodation with gas central heating and Upvc double glazing and represents a superb opportunity in this very convenient address. Hit the "Request a Viewing" or "Contact Agent" buttons today!