

Glebe Road, Alvechurch, B48 7PS

Fixed Price £275,000

🛏️ 2 🚿 1 🚗 1



****PLEASE QUOTE REFERENCE VF0354*****Are you a first time buyer seeking a modern & move in ready home in the sought after village location of Alvechurch? This could be the one for you!

Key Features

- QUOTE REFERENCE VF0354
- QUIET CUL DE SAC
- MODERN KITCHEN DINER
- TWO BEDROOMS
- GENEROUS REAR GARDEN
- SOUGHT AFTER VILLAGE LOCATION
- SEMI DEATCHED PROPERTY
- SPACIOUS LOUNGE
- FAMILY BATHROOM
- OFF ROAD PARKING

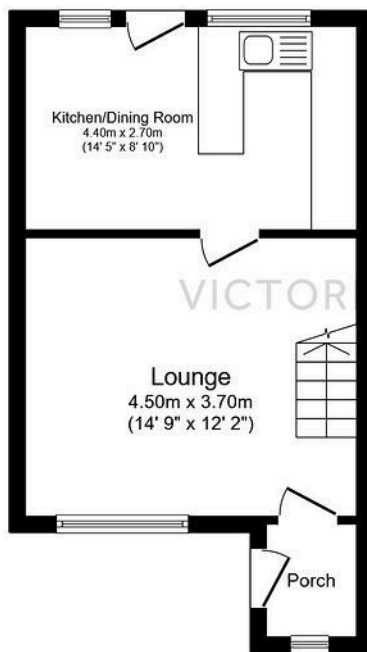

Ground Floor
Floor area 30.5 m² (329 sq.ft.)

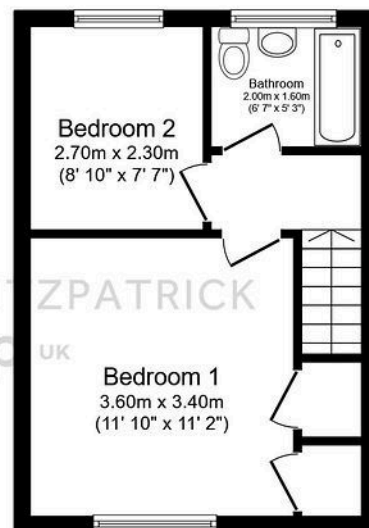

First Floor
Floor area 28.6 m² (308 sq.ft.)

TOTAL: 59.1 m² (636 sq.ft.)

This floor plan is for illustrative purposes only. It is not drawn to scale. Any measurements, floor areas (including any total floor area), openings and orientations are approximate. No details are guaranteed, they cannot be relied upon for any purpose and do not form any part of any agreement. No liability is taken for any error, omission or misstatement. A party must rely upon its own inspection(s).