

### 3 Badgers Retreat, off Comberton Road, Kidderminster.

£335,000

🛏 3 🚿 2 🚗 1



- Quote Reference PC0649
- Well Presented Three Bedroom Detached Home. Built 2022
- Convenient Location To Bromsgrove/ Worcester Side of Kidderminster
- Close to Open Countryside
- Lounge and Kitchen / Dining Room
- Good Sized Rear Garden
- Close to All Local Amenities
- Good Size Driveway
- Early Viewing Advised
- Hit the 'Request Details' or 'Email Agent' button to secure your viewing now!

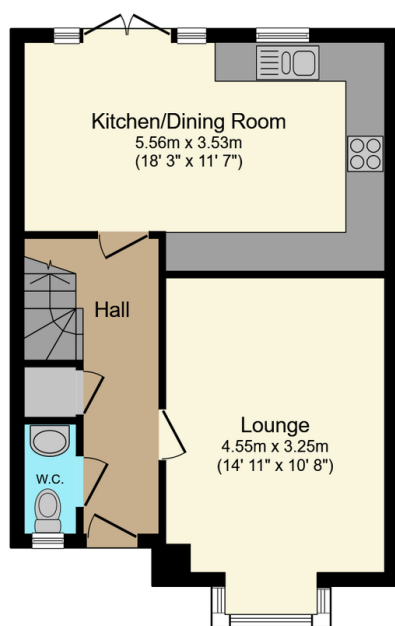

Ground Floor

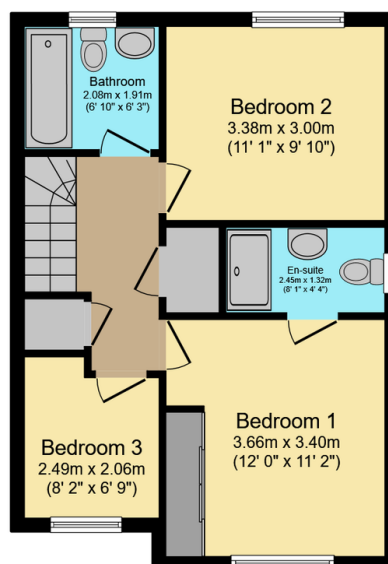
Floor area 45.1 m<sup>2</sup> (486 sq.ft.)

First Floor

Floor area 44.2 m<sup>2</sup> (476 sq.ft.)TOTAL: 89.3 m<sup>2</sup> (961 sq.ft.)

This floor plan is for illustrative purposes only. It is not drawn to scale. Any measurements, floor areas (including any total floor area), openings and orientations are approximate. No details are guaranteed, they cannot be relied upon for any purpose and do not form any part of any agreement. No liability is taken for any error, omission or misstatement. A party must rely upon its own inspection(s). Powered by www.Propertybox.io

Quote Reference PC0649. Click the 'Request Details' or 'Email Agent' button to book a viewing now! Well presented modern detached family home with three generous sized bedrooms, on a well-located plot with woodland views to the front and rear, must be viewed to be appreciated. Completed by renowned developer Cameron Homes in 2022 with around eight years NHBC building guarantee remaining. Located within The Willows development on the southern edge of Kidderminster giving easy access to local amenities and superb transport links by road and rail

PHIL COOK



@ phil.cook@exp.uk.com

philcook.exp.uk.com

07508 423 891

to Worcester, Bromsgrove, Birmingham and to the motorway network. Double glazed and central heating throughout. Hit the 'Request Details' or 'Email Agent' button to secure your viewing now!