

# 1a Heathfield Crescent, Kidderminster

Guide Price £325,000

🛏 2 🍴 1 🚗 1



- Quote Reference PC0649
- Sought After Area to the Bewdley Side of Kidderminster
- Detached
- Refitted Kitchen
- Potential to Create 3rd Upstairs Bedroom
- Quiet Cul de Sac Location
- Close to Brintons Park
- Good Sized Landscaped Garden
- Refitted Shower Room
- Hit the 'Request Details' or 'Email Agent' button to secure your viewing now!



### Ground Floor

Floor area 75.4 m<sup>2</sup> (811 sq.ft.)

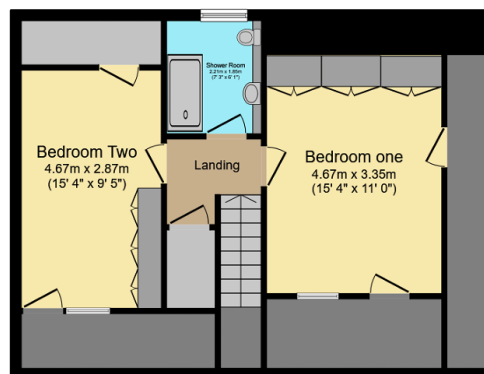

### First Floor

Floor area 47.6 m<sup>2</sup> (513 sq.ft.)

TOTAL: 123.0 m<sup>2</sup> (1,324 sq.ft.)

This floor plan is for illustrative purposes only. It is not drawn to scale. Any measurements, floor areas (including any total floor area), openings and orientations are approximate. No details are guaranteed, they cannot be relied upon for any purpose and do not form any part of any agreement. No liability is taken for any error, omission or misstatement. A party must rely upon its own inspection(s). Powered by www.Propertybox.io

Quote Reference PC0649. Hit the 'Request Details' or 'Email Agent' button to secure your viewing now! A superb opportunity for anyone looking for a detached family home with excellent gardens in Kidderminster. Two (potentially three) bedroomed detached home in a quiet residential Cul-de-Sac near to Brintons Park on the Bewdley side of Kidderminster. The property comprises of Lounge/Dining room, refitted Kitchen/dining room and a W.C on the ground floor. To the first floor there are two good sized bedrooms and a family bathroom. Potential to create a third bedroom on the first floor by extending existing rear dormer. To the rear of the property there is a

PHIL COOK



@ phil.cook@exp.uk.com

philcook.exp.uk.com

07508 423 891

well kept garden and to the front a driveway offering parking and leading to garage. The property has central heating throughout. This is a must see property to appreciate its possibilities as a detached family home. Hit the 'Request Details' or 'Email Agent' button to secure your viewing now!