

156 High Street, Lye

Guide Price £89,950

🛏 1 🚿 1 🚺 1

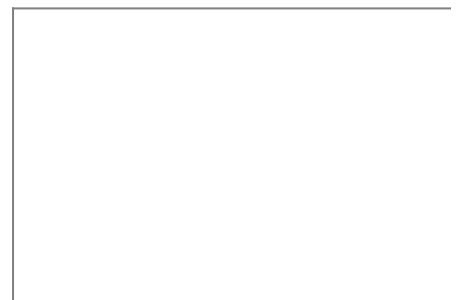
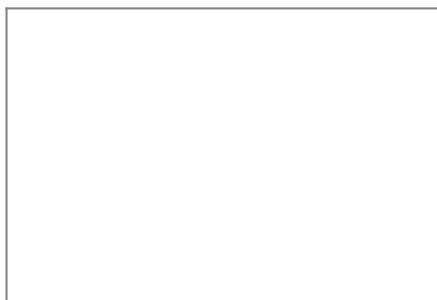

Quote Reference JS0667 Very conveniently situated close to the day to day amenities of Lye High Street, this One Bedroom Second Floor Flat provides well planned gas centrally heated and Upvc double glazed accommodation which although requires updating and improvement offers good potential for the First Time Buyer or Investor. Handy for public transport links including Lye Railway Station and road routes to Stourbridge, Halesowen and the Merry Hill Centre the accommodation briefly comprises: Communal Entrance Lobby with staircases, Reception Hall with ample storage cupboards, spacious Lounge, Kitchen, good sized Bedroom, Bathroom and communal gardens. Hit the "Request Details" or "Email Agent" button to secure your viewing !

Key Features

- Quote Reference JS0667
- Gas Central Heating
- Ideal for First Time Buyers or Investors
- 106 Years Remaining on Lease
- Well Proportioned Rooms
- One Bed Second Floor Flat
- Updating Required But Good Potential
- Very Convenient Location
- Upvc Double Glazing

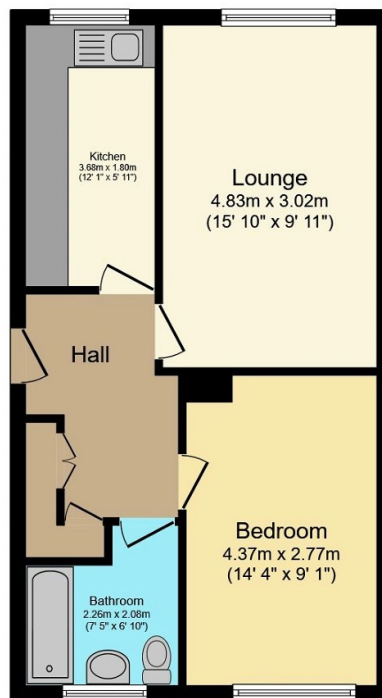

Floor Plan

Total floor area 46.0 m² (495 sq.ft.) approx

This plan is for illustration purposes only and may not be representative of the property. Plan not to scale. Powered by PropertyBox