



ROSS BURBIDGE

exp

@ ross.burbidge@exp.uk.com

🌐 rossburbidge.exp.uk.com

☎ 07792 512 628

Grove Mews, Town Centre, Cheltenham, GL50

Guide Price £300,000

🛏 2 🍽 2 🚿 1



Please Quote: RB1393. Tucked away within a private mews development and offered with No Onward Chain, this modern two-bedroom terrace home offers stylish, low-maintenance living just a short walk from Cheltenham town centre.

The light and spacious open plan living area combines kitchen, dining and lounge spaces, with contemporary finishes, integrated appliances, and French doors opening to a private courtyard garden.

Upstairs are two double bedrooms, including a main bedroom with built-in storage and en-suite shower room, plus a modern family bathroom.

Outside, the enclosed courtyard provides an easy-care outdoor space, while an integral carport offers covered off-road parking.

Grove Mews is ideally positioned close to Waitrose, the Honeybourne Line, Cheltenham Spa station and the town's excellent shops, cafés and restaurants – perfect for professionals, downsizers or young families.

Tenure: Freehold
Council Tax Band: C



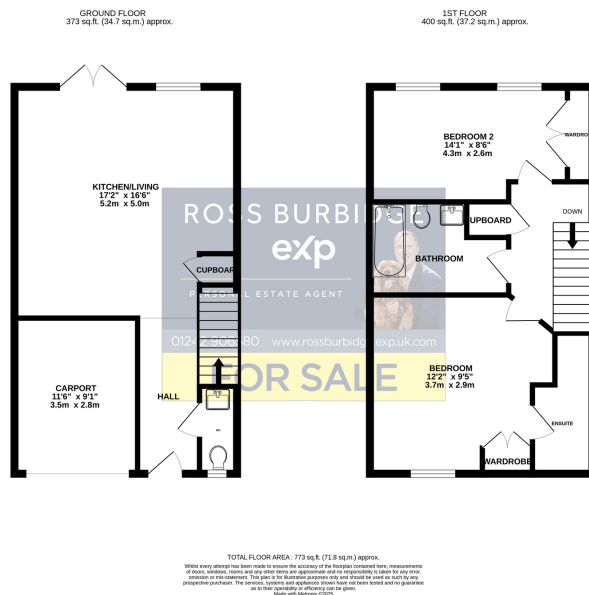

- Two Double Bedrooms
- End-Terraced
- Please Quote: RB1393
- Carport
- En-Suite Bedroom
- Rear Garden
- Lounge/Reception Room
- Stunning Kitchen
- No Onward Purchase

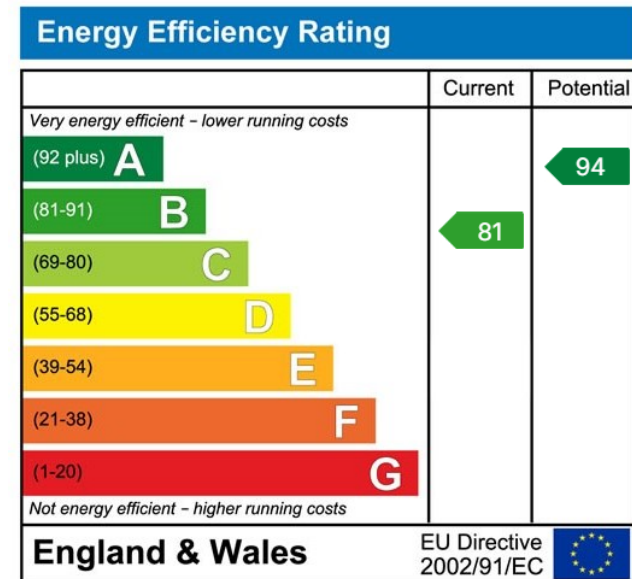

eXp World UK Limited is a registered company at c/o Corporation Service Company (UK) Limited, 114 St. Martin's Lane London WC2N 4BE.

Registered company number is 12016573. VAT Registration Number is 327 4120 29