



Speer Court, Thomas Wyatt Road, Devizes, SN10

Offers In Region Of £315,000

🛏 2 🚿 1 🛋 1

- Two Bedrooms
- Grade II Listed
- Presented in lovely condition
- Former hospital conversion
- Ready to just move in to and enjoy
- Downstairs WC
- Allocated off street parking space
- Extensive communal grounds space
- Visitor Parking
- Gas Central Heating



Welcoming you to this beautifully presented Victorian Bath Stone Grade II Listed home which has been interior designed and is presented in high specification and ready to move in. The property includes high ceilings and large sash windows which really encompasses the period feel to the property.





Ground Floor
Floor area 39.3 sq.m. (423 sq.ft.)

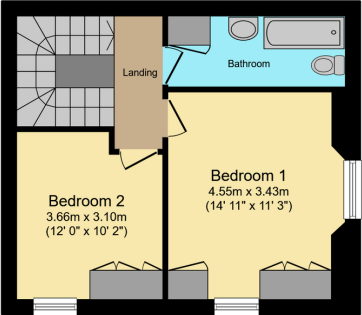

First Floor
Floor area 39.3 sq.m. (423 sq.ft.)

Total floor area: 78.6 sq.m. (846 sq.ft.)

This floor plan is for illustrative purposes only. It is not drawn to scale. Any measurements, floor areas (including any total floor area), openings and orientations are approximate. No details are guaranteed, they cannot be relied upon for any purpose and do not form any part of any agreement. No liability is taken for any error, omission or misstatement. A party must rely upon its own inspection(s). Powered by www.propertybox.io

