

16 Snell Drive, Latchbrook

Guide Price £315,000

4 1 1



Upon entering, you are welcomed by a generously sized entrance hall that provides a wonderful sense of space and flow throughout the property. The ground floor features a bright and spacious living room with bay window, perfect for relaxing or entertaining, along with a convenient downstairs WC. At the heart of the home lies the stylish fitted kitchen/diner, boasting modern finishes, ample storage, and room for dining—creating an inviting space for family meals and gatherings. Upstairs, the property offers four double bedrooms, each finished to a high standard, complemented by a modern family bathroom. Externally, you'll find an enclosed south-facing garden, providing a sunny, private outdoor retreat. The property also benefits from driveway parking and a detached single garage.

Key Features

- Freehold - Council Tax Band D - EPC D
- Four Double Bedrooms
- Spacious Living Room
- Modern Bathroom
- Driveway Parking & Detached Single Garage
- Immaculately Presented Semi-Detached Home
- Stylish Fitted Kitchen/Diner
- Generously Sized Entrance Hall & Downstairs WC
- Enclosed South-Facing Garden
- Quote BH0675 To Book Your Viewing

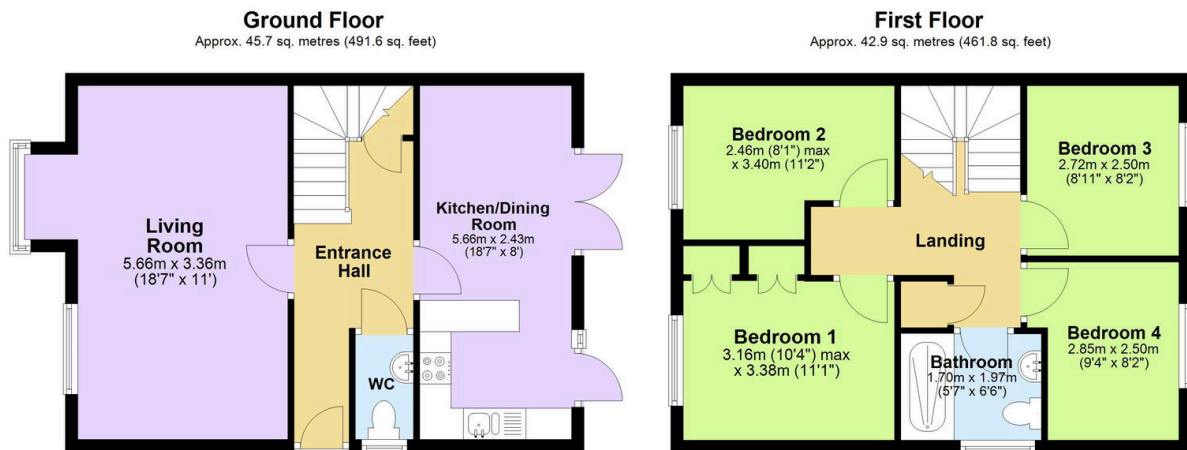

Total area: approx. 88.6 sq. metres (953.4 sq. feet)