



4 Rectory Close Bondend Road, Upton St. Leonards

£685,000

 4  2  2



- SPACIOUS AND WELL PRESENTED DETACHED HOME
- 3 FURTHER GENEROUS BEDROOMS
- COMFORTABLE LIVING ROOM
- STUNNING KITCHEN/DINER/FAMILY SPACE
- WELL LOCATED FOR LOCAL AMENITIES
- HUGE MASTER BEDROOM SUITE
- WELL APPOINTED FOUR-PIECE BATHROOM
- ORANGERY STYLE CONSERVATORY
- DOUBLE GARAGE AND 3-4 CAR DRIVEWAY
- REF DH0109

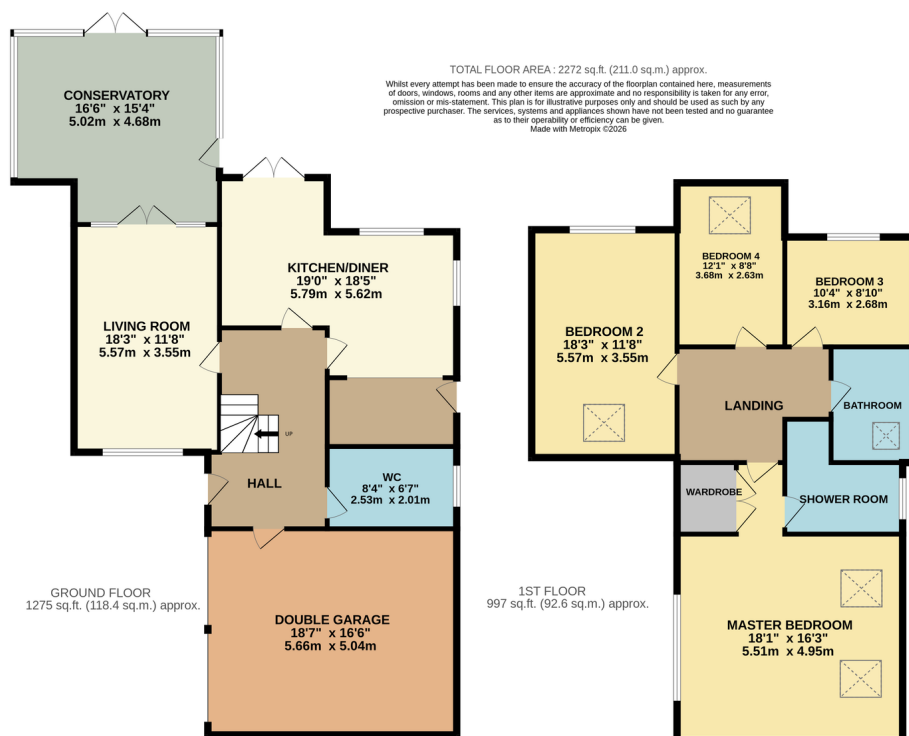

Ref DH0109: Daryl Hill is pleased to present to this market this beautiful family home in a no through road setting within the delightful Village of Upton St Leonards. The stylish and particularly spacious home is very well presented and is ideal for those looking for a long term family home to grow into and enjoy. With a cavernous master bedroom suite complemented by three further generous bedrooms with a comfortable living room, stunning orangery style conservatory, fantastic kitchen/diner/family space and impressive double garage.

The gardens wrap to rear and side, and of proportions that I consider easy to maintain with space to enjoy and to the front there is a driveway for 3-4 cars.