

Lyndon Court, Pillmere, Saltash, PL12 6XX

Guide Price £190,000

2 1 1



Ascending to the first floor, you'll find a roomy landing that provides access to all principal rooms. The heart of the home is the open-plan lounge/diner, which benefits from an abundance of natural light, creating a wonderfully bright and spacious living area. A particular highlight is the modern kitchen, which features a stylish window opening into the lounge/diner – an innovative design touch that creates a sense of flow and connectivity, perfect for entertaining or everyday family living. The home boasts two generously proportioned double bedrooms, both offering comfortable accommodation and flooded with natural light. The modern bathroom completes the first-floor accommodation. The property also benefits from the convenience of a garage and an off-road parking space.

Key Features

- Freehold - Council Tax Band B - EPC TBC
- Open Plan Lounge/Diner/Kitchen
- Versatile Storage/Office Space
- Bright & Airy Living Spaces
- Convenient Access To Bus Routes, Walks & Local Amenities
- Two Double Bedrooms
- Modern Bathroom
- Garage & Off Road Parking
- Immaculately Presented
- Quote BH0675 To Book Your Viewing

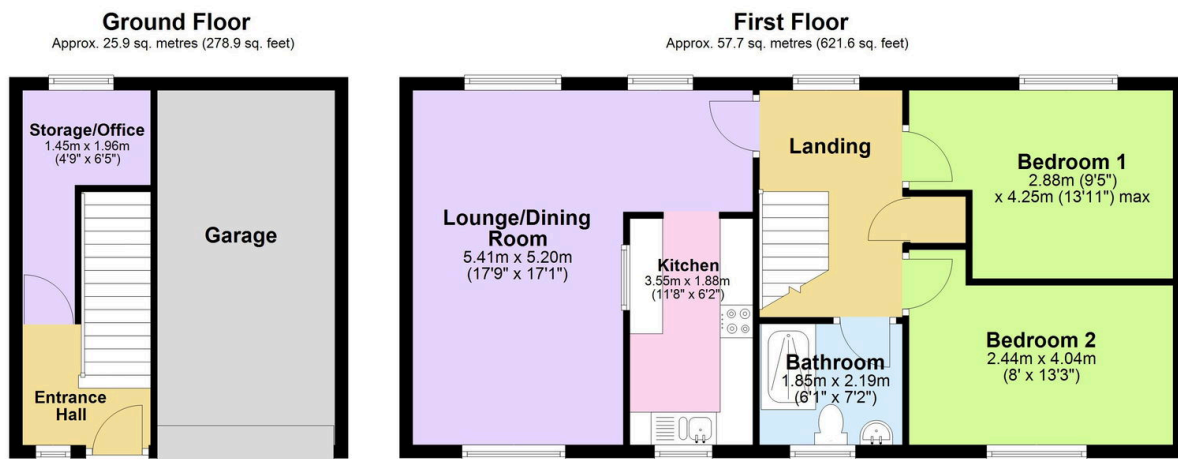

Total area: approx. 83.7 sq. metres (900.5 sq. feet)