



SCOTT WINDLE POWERED BY exp TM UK

@ scott.windle@exp.uk.com

scottwindle.exp.uk.com

07838 311 550

Fair View, Colerne

Guide Price £400,000

🛏 4 🚿 2 🛋 1



Reference; SW0341

Located in a semi rural setting just a short distance from the pretty and highly sought after village of Colerne, this extended four bedroom semi detached property with double garage offers a perfect blend of countryside charm and modern living, ideal for a growing family.

The accommodation is arranged over two floors and in brief comprises; Sitting room with wood burner, spacious kitchen / dining room, utility room and downstairs cloakroom. To the first floor are four bedrooms, the master with en-suite shower room, and a family bathroom.

Outside, to the rear is a good size garden laid mainly to lawn whilst to the front is a double garage with parking in front.

The property is positioned close to a number of countryside walks and enjoys an open outlook to the front, giving a real sense of space. This well presented home is perfectly suited to families seeking peaceful surroundings while staying within easy reach of local amenities in Colerne and the nearby town of Chippenham.

Early viewing is highly recommended to appreciate all that this lovely property has to offer. No onward chain.

***** PLEASE QUOTE REFERENCE; SW0341 *****

Property Information

Freehold

Council Tax Band; C

Gas Fired Central Heating

EPC Rating; C

No Onward Chain



Fair View, Colerne, Chippenham, SN14

Approximate Area = 1224 sq ft / 113.7 sq m
 Limited Use Area(s) = 71 sq ft / 6.5 sq m
 Garage = 308 sq ft / 28.6 sq m
 Total = 1603 sq ft / 148.8 sq m
 For identification only - Not to scale

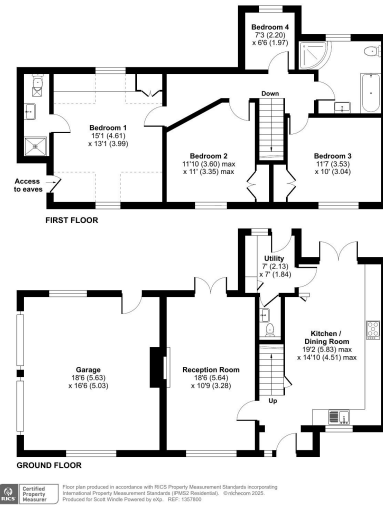

- Please Quote Reference SW0341
- Sought After Village
- Four Bedroom Semi Detached House
- Family Bathroom, En-Suite & Downstairs Cloakroom
- Double Garage With Parking In Front
- Semi Rural Position
- Extended & Well Presented
- Sitting Room, Kitchen / Dining Room & Utility Room
- Good Size Rear Garden & Pleasant Outlook To Front
- No Onward Chain



77

82

eXp World UK Ltd is a registered company at Level 37, 25 Canada Square, London, E14 5LQ.

Registered company number is 12016573. VAT Registration Number is 327 4120 29