



SARAH FUDGE

POWERED BY
exp™ UK

@ sarah.fudge@exp.uk.com

🌐 sarahfudge.exp.uk.com

☎ 01202 985301

Upton, Poole, Dorset

Offers In Region Of £495,000

3 2 1



- Three Double Bedrooms
- Lounge / Diner
- Modern Kitchen
- Driveway & Off Road Parking
- Lovely Location and within catchment for Lytchett Minster School
- First Floor Master Suite with Dressing Area and En-Suite Bathroom & WC
- Ground Floor Shower Room & WC
- Detached Garage with Electric Door
- Gardens
- To view quote Ref - 1214753



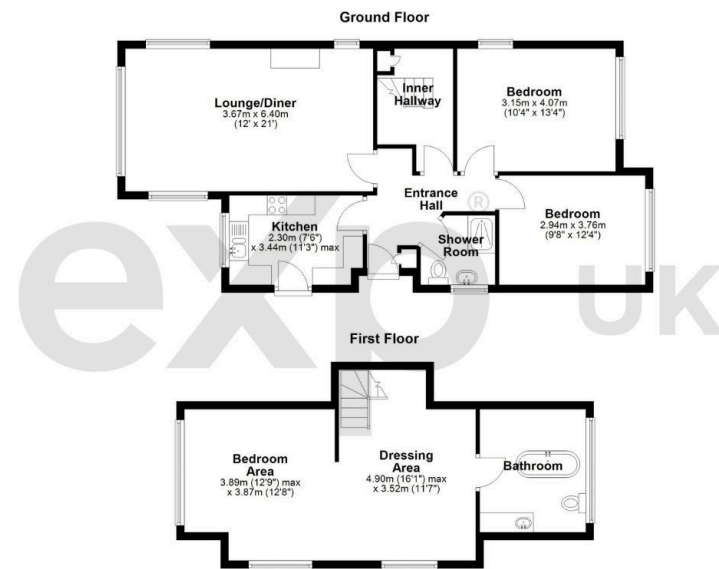
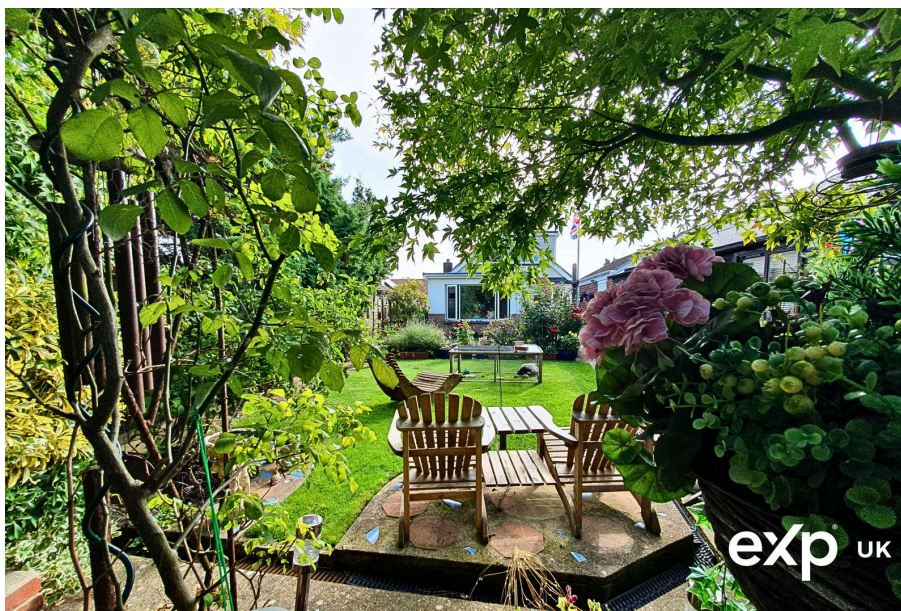

Bournemouth Energy Floor Plans are provided for illustration/identification purposes only. Not drawn to scale, unless stated and accept no responsibility for any error, omission or mis-statement. Dimensions shown are to the nearest 7.5 cm/3 inches. Total appox area shown on the plan may include any external terraces, balconies and other external areas. To find out more about Bournemouth Energy please visit www.bournemouthenergy.co.uk (Tel: 01202 506006) Plan produced using PlanIt

Three double bedroom detached family home. Oversized first floor master bedroom suite with dressing area and own bathroom & WC, on the ground floor two double bedrooms, lounge / diner, modern kitchen, shower room and WC, detached garage, gardens, parking, motivated seller.... within easy reach of Lytchett Bay, Upton Country Park and in catchment for Upton Infants & Junior School and Lytchett Minster School. To view this fabulous property quote ref: 1214753



eXp World UK Ltd is a registered company at Level 37, 25 Canada Square, London, E14 5LQ.

Registered company number is 12016573. VAT Registration Number is 327 4120 29