

## 46 Chaddlewood Avenue,

Guide Price £265,000

4 1 2



Discover exceptional living in Plymouth's desirable St Judes neighborhood with this substantial property, where period character meets modern convenience throughout. The heart of the property is a stunning reception room featuring a magnificent bay window that bathes the space in natural light throughout the day. The ground floor flows seamlessly through to a separate dining room perfect for entertaining, while the bright, modern kitchen provides excellent natural light and contemporary functionality. A convenient downstairs WC completes the ground floor accommodation. Upstairs, four generously proportioned double bedrooms offer abundant space for the whole family, each benefiting from high ceilings and large windows that enhance the sense of space and light. The contemporary family bathroom serves the bedrooms well.

## Key Features

- Freehold - Council Tax Band B - EPC TBC
- Four Well-Proportioned Bedrooms
- Separate Dining Room
- Downstairs WC
- Excellent Location
- Spacious Period Property
- Gorgeous Living Room With Bay Window
- Bright & Airy Kitchen
- Lovely Sized Courtyard Garden
- Quote BH0675 To Book Your Viewing

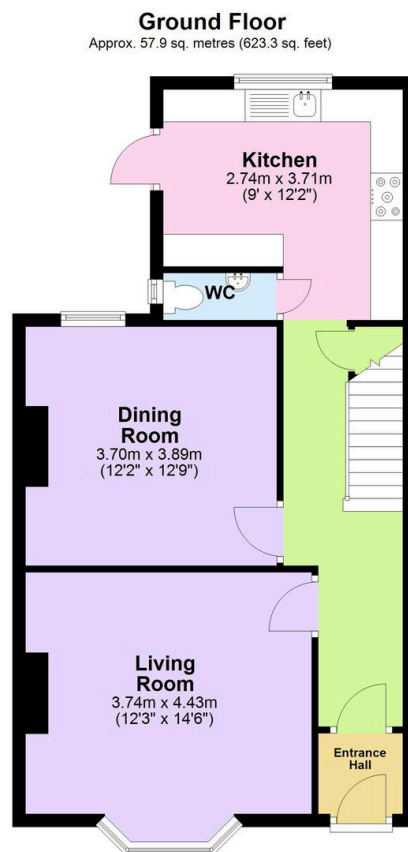

Total area: approx. 115.9 sq. metres (1247.4 sq. feet)