



ANDY RICHARDSON POWERED BY **exp** TM UK

@ andy.richardson@exp.uk.com

📞 01202 985 153 / 07470 475 993

🌐 andyrichardson.exp.uk.com

Warminster Road, South Newton, Salisbury, SP2 0QD

Guide Price £1,175,000

5 4 3



- Reference AR0108
- Stunning, luxury new build detached home
- 4000sq ft of accommodation • 5 bedrooms and 4 bathrooms set over 3 floors
- Bespoke hand made kitchen with central island, drinks bar, and twin dishwashers
- 10 metre main living room/ kitchen with 2 further reception rooms
- Sauna, hot tub and outdoor kitchen
- Utility room and garage kitchen
- Electric gates providing secure off road parking
- Viewings available via the sole agent, Andy Richardson



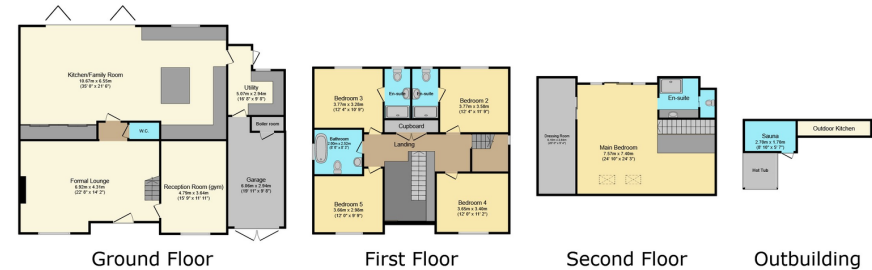

A stunning new-build detached home of approx. 4,000 sq ft, set over three floors in the desirable village of South Newton. This five bedroom, four bathroom property combines contemporary luxury with exceptional attention to detail. Behind secure electric gates, the house welcomes you with a striking double-height entrance. The expansive 10-metre open-plan living area is the heart of the home, featuring a bespoke handmade kitchen. Two additional reception rooms offer flexibility. The first floor comprises four spacious bedrooms, two with ensuites, and a stylish family bathroom. The entire second floor is dedicated to a luxurious master suite with a dressing room and ensuite bathroom. A truly impressive family home blending space, elegance and modern comfort in a sought-after Wiltshire location.



eXp World UK Ltd is a registered company at Level 37, 25 Canada Square, London, E14 5LQ.

Registered company number is 12016573. VAT Registration Number is 327 4120 29