

Station Road, Bere Alston, PL20

Guide Price £110,000

1 1 1



A spacious and well-presented one-bedroom ground floor apartment, situated in the heart of a popular Devon village and just moments from local amenities. Offered to the market with no onward chain, the property benefits from off-road parking, a private courtyard garden, and would make an ideal first-time buy or investment purchase.

Bere Alston is a tranquil Devon village and a designated World Heritage Site. The village features a well-regarded primary school, a pub, several shops, eateries, post office, bakery, butchers, doctors' surgery, and pharmacy.

Key Features

- TO ARRANGE A VIEWING PLEASE QUOTE BL0650
- One Bedroom
- No Onward Chain
- Courtyard Garden
- Open Plan Living Area
- Ground Floor Apartment
- Village Centre Location
- Perfect First Time Buy Or Investment
- Allocated Parking Space
- Modern Bathroom

Station Road, Bere Alston, Yelverton, PL20

Approximate Area = 475 sq ft / 44.1 sq m

For identification only - Not to scale

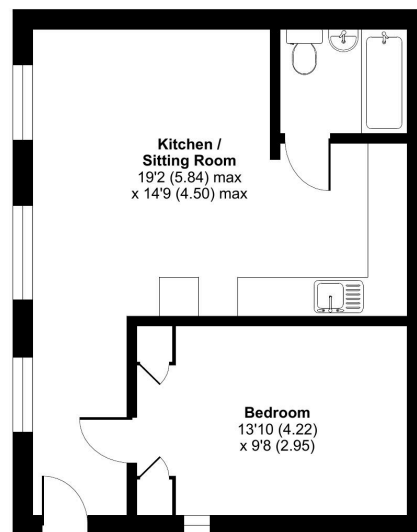

GROUND FLOOR

Floor plan produced in accordance with RICS Property Measurement Standards incorporating International Property Measurement Standards (IPMS2 Residential). ©richcom 2025. Produced for Ben Estates TA Ben Langton Powered By exp. REF: 128573