



LEE RAWSON

POWERED BY
exp UK

Larchdale Close, Warsash

Offers Over £430,000

🛏 4 🚿 2 🛋 2



Nestled in the sought-after Larchdale Close in Warsash, this charming semi-detached house presents a wonderful opportunity for comfortable living. Boasting a well-designed layout across two floors, this property offers a blend of space and practicality.

The ground floor welcomes you with a spacious lounge, perfect for relaxing and entertaining. Adjacent is a separate dining room, ideal for family meals and gatherings. The kitchen is thoughtfully designed, offering ample space for culinary adventures. Completing the ground floor is a convenient entrance hall, toilet and a practical garage, providing valuable storage and a driveway for two cars.

Ascending to the first floor, you'll find three well-proportioned bedrooms and a single fourth bedroom, offering comfortable retreats. The master bedroom provides a peaceful sanctuary and benefits from having an en-suite. A family bathroom serves the bedrooms, ensuring convenience for all. The landing connects the rooms and provides access to all areas of the first floor.

Externally, the property benefits from its semi-detached position, often providing a good degree of privacy. Located in Larchdale Close, residents can enjoy the peaceful surroundings of Warsash, a charming village known for its coastal location and community feel.

This property offers a fantastic opportunity to embrace a comfortable lifestyle in a desirable location. Don't miss the chance to make this house your home. Contact me today to arrange a viewing!





- Four Bedroom Semi Detached House
- Spacious Lounge
- Separate Kitchen and dining room
- Downstairs W/C room
- Master Bedroom with En-suite
- Family Bathroom
- Generous sized Garden
- Large Garage
- Driveway

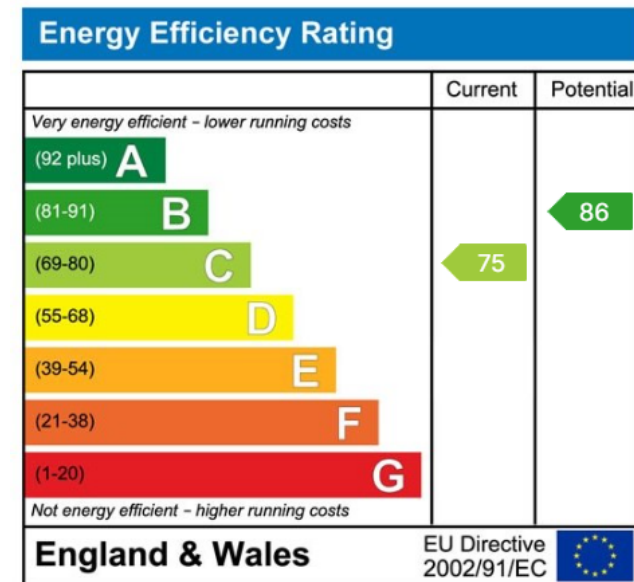
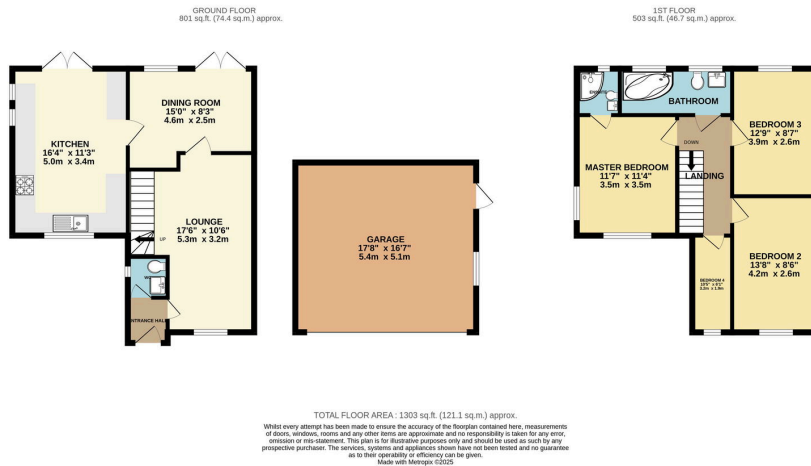

LEE RAWSON

POWERED BY
exp UK