

## Hoe Gardens, Plymouth, PL1

Guide Price £420,000

4 2 2



A beautifully appointed, Grade II Listed double-fronted Victorian residence, nestled within private gardens and just a short walk from the Barbican, The Hoe, and Plymouth City Centre. This elegant period property offers spacious and versatile accommodation, making it ideal for families, multi-generational living, or hosting guests. It also presents an attractive investment opportunity, as the current owners run a successful holiday let business, renting out the two lower ground floor bedrooms.

Key Features

- 
- 
- 
- 
- 
- 

Hoe Gardens, The Barbican, Plymouth, PL1

APPROX. GROSS INTERNAL FLOOR AREA 1564 SQ FT 145.2 SQ METRES (EXCLUDES STORE)

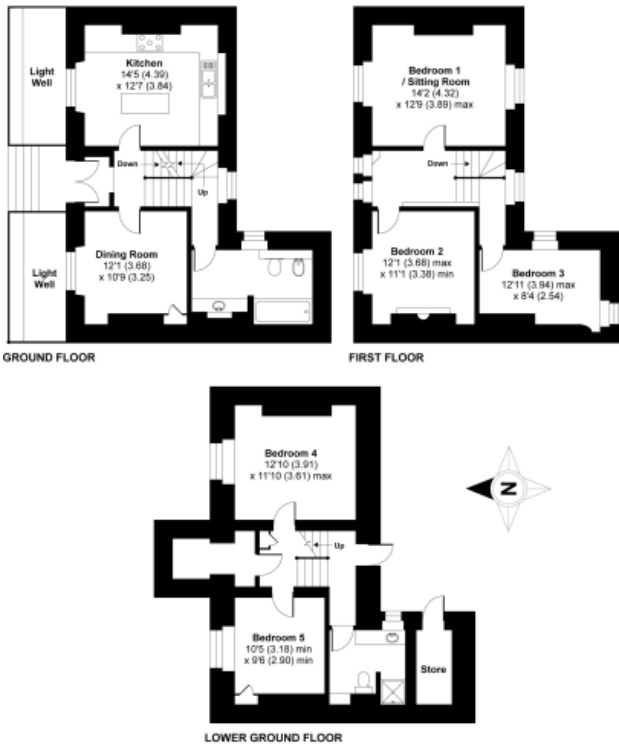

Whilst every attempt has been made to ensure the accuracy of the floor plan contained here, measurements of doors, windows and rooms are approximate and no responsibility is taken for any error, omission or misstatement. These plans are for representation purposes only as defined by RICS Code of Measuring Practice and should be used as such by any prospective purchaser. Specifically no guarantee is given on the total square footage of the property if quoted on this plan. Any figure given is for initial guidance only and should not be relied on as a basis of valuation.

Copyright nichecom.co.uk 2015 Produced for Atwell Martin REF : 66069