

Edwards Crescent, Latchbrook

Guide Price £295,000

3 1 1



Positioned in the sought-after Latchbrook area of Saltash, this bright and airy semi-detached home offers generous family accommodation throughout. The ground floor welcomes you into a spacious porch entrance with a handy downstairs wc, leading to the generously sized lounge/diner, which is filled with natural light and flows into the separate modern fitted kitchen. Upstairs, you'll find a newly fitted modern family bathroom and three well-proportioned bedrooms, with the primary benefitting from beautiful countryside views. Outside, a wonderful enclosed rear garden awaits, mainly laid to lawn and a patio area - perfect for alfresco dining. To the front, a driveway provides off-road parking for multiple vehicles and leads to a detached single garage, offering additional storage space.

Key Features

- Freehold - Council Tax Band C - EPC TBC
- Three-Well Proportioned Bedrooms
- Spacious Lounge/Diner
- New Family Bathroom
- Driveway Parking & Detached Single Garage
- Immaculately Presented Semi-Detached Home
- Handy Porch and WC Extension
- Modern Fitted Kitchen
- Enclosed Rear Garden
- Quote BH0675 To Book Your Viewing Today

Ground Floor

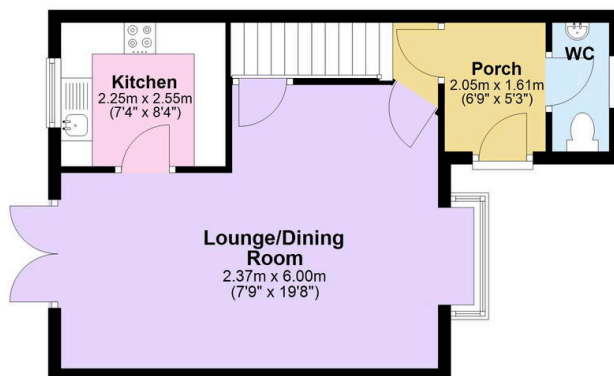

First Floor

