



HEATHER PORTER

exp[®] UK

@heather.porter@exp.uk.com

heatherporter.exp.uk.com

07811 129 251

117 Ruskin Crescent
£210,000

3 1 1



- Quote HP0686 for viewing/enquiries
- Bright lounge with feature fireplace
- Modern kitchen with integrated oven & hob
- Three bedrooms
- New roof, double glazing and central heating throughout
- Well presented family home - ideal for first-time buyers & growing families
- Separate dining area perfect for family meals
- Downstairs WC and upstairs shower room
- Enclosed front and rear gardens
- Popular location close to local amenities



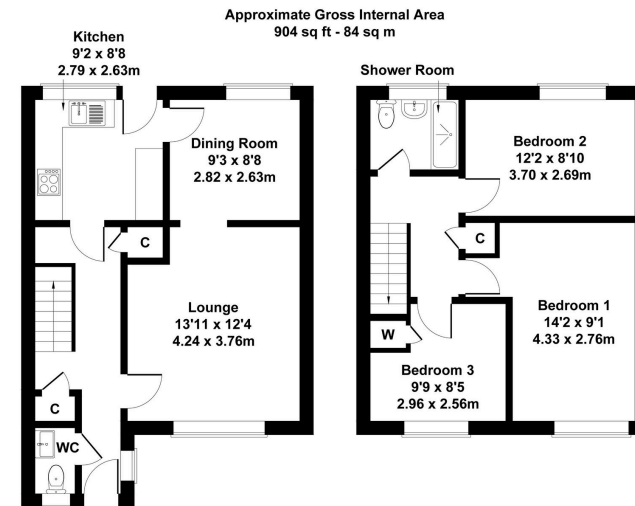

Not to Scale. Produced by The Plan Portal 2025
For Illustrative Purposes Only.

Welcome to this much loved family home in the sought-after area of Crownhill, offering spacious living accommodation throughout which is perfect for both first-time buyers and growing families alike.

