

**Middle Stoke, Limpley Stoke, Bath, BA2 7GF**

Guide Price £265,000

🛏 2 🚿 1 🛋 1



- Property Reference SL 0822 - Simon Lord
- Classic Grade II Listed period house
- Charming village location just outside the city
- Well presented living space over three floors
- Two bedrooms
- Living/Dining Room, Kitchen/Breakfast Room
- Modern period style bathroom
- Terrace garden
- No onward chain
- VIEWING DATES TO BE ADVISED

LOWER GROUND FLOOR



GROUND FLOOR

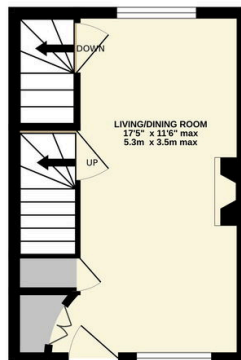

1ST FLOOR

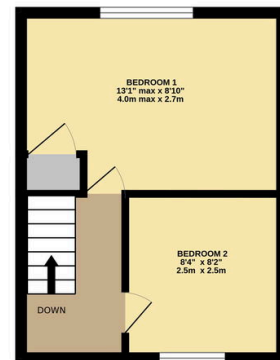

Whilst every attempt has been made to ensure the accuracy of the floorplan contained here, measurements of doors, windows, rooms and any other items are approximate and no responsibility is taken for any error, omission or mis-statement. This plan is for illustrative purposes only and should be used as such by any prospective purchaser. The services, systems and appliances shown have not been tested and no guarantee as to their operability or efficiency can be given.  
Made with Metropix ©2025

A charming two-bedroom period house, Listed Grade II and forming part of a short terrace at the heart of Limpley Stoke, a highly favoured village just to the south of the city.