

Penleigh Road, Westbury BA13 3QB

£400,000

🛏 3 🚿 2 🛋 2



Ref: MT1071 Recently constructed in 2022, this detached bungalow has been built to a bespoke, high specification design, to offer the very best of open-plan styling with three double bedrooms; spacious dual aspect living room with bi-fold doors to the rear garden and a media wall; a stunning fitted kitchen with breakfast bar and integrated appliances; a second reception room which could serve as a fourth bedrooms; well appointed family bathroom and en-suite shower room to the master bedroom.

Key Features

- Ref: MT1071
- Three double bedrooms
- Stunning kitchen
- En-suite shower room to master
- Low maintenance garden and ample secure parking within gated drive
- Modern detached bungalow constructed in 2022 to a high specification
- Open plan styled living room
- Second reception room
- Superbly appointed family bathroom
- Offered with no onward chain!

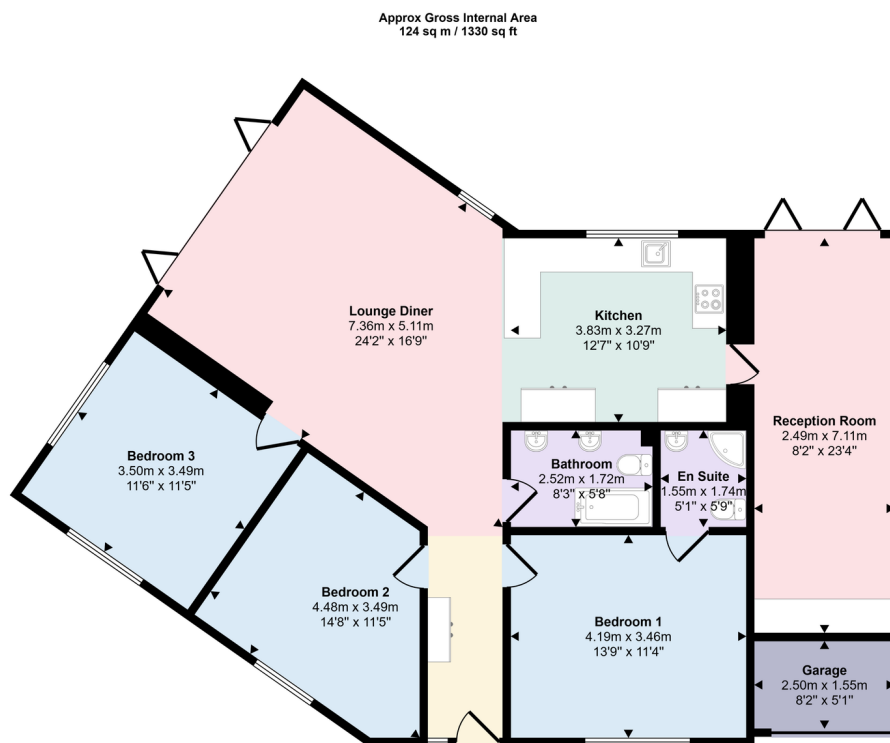

Floorplan

This floorplan is only for illustrative purposes and is not to scale. Measurements of rooms, doors, windows, and any items are approximate and no responsibility is taken for any error, omission or mis-statement. Icons of items such as bathroom suites are representations only and may not look like the real items. Made with Made Snappy 360.