

Sunnybanks, Hatt, Saltash, PL12 6SA

Guide Price £250,000

3 1 1

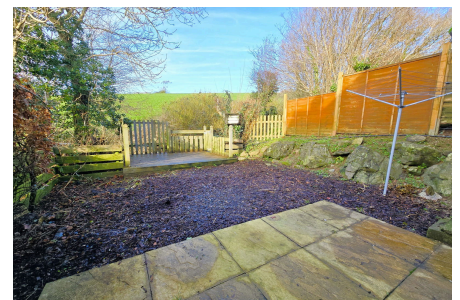

The well-appointed accommodation features a spacious, light-filled lounge/dining room with patio doors that seamlessly connect to the private rear garden - perfect for indoor/outdoor living and entertaining. The separate kitchen is equipped for modern family life, while upstairs, three well-proportioned bedrooms provide comfortable family accommodation. The modern family bathroom serves the bedrooms, completing the internal layout. Outside, the secluded garden provides a tranquil retreat, while the single garage and driveway offer convenient off-road parking. The property's quiet setting combined with its countryside views and practical living space makes this an ideal family home in a sought-after location.

Key Features

- Freehold - Council Tax Band B - EPC C
- Three Well-Proportioned Bedrooms
- Fitted Kitchen
- Single Garage
- No Onward Chain
- Fantastic Terraced Home
- Spacious Lounge/Diner
- Secluded Rear Garden With Countryside Views
- Driveway Parking
- Quote BH0675 To Book Your Viewing

Ground Floor

Approx. 39.8 sq. metres (428.9 sq. feet)

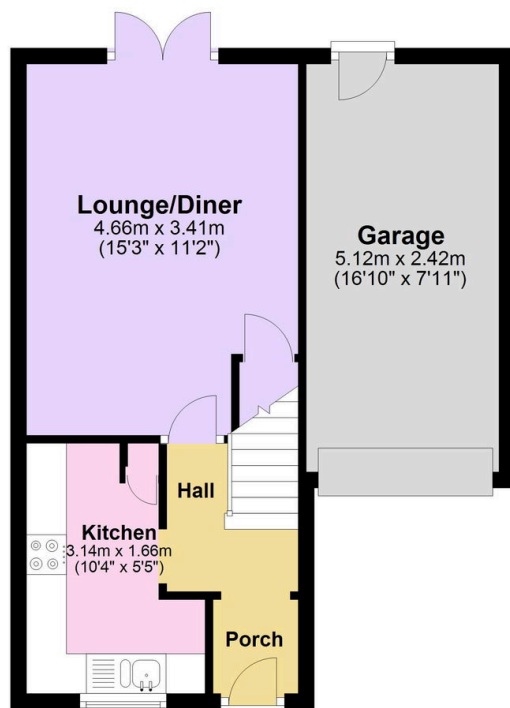

First Floor

Approx. 40.5 sq. metres (436.2 sq. feet)

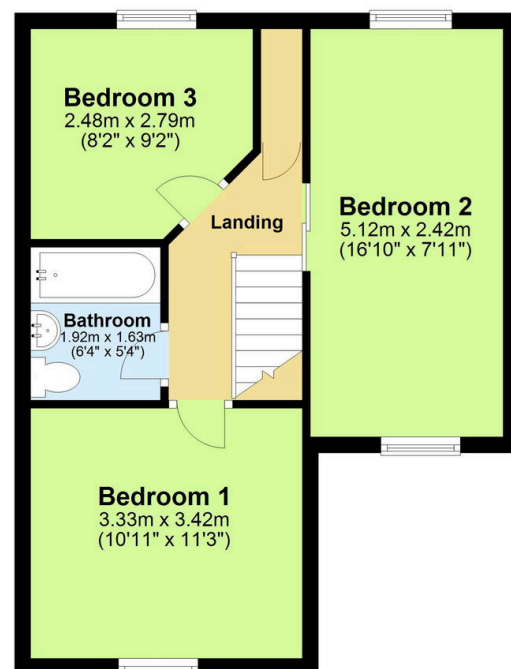

Total area: approx. 80.4 sq. metres (865.0 sq. feet)