

4 Deer Park

Guide Price £425,000

4 2 2



The property has a versatile layout with two double bedrooms on the ground floor, along with a contemporary shower room providing single-level living with the added flexibility of a further two double bedrooms upstairs. The heart of the home is its stunning open-plan family room, with a stylish modern fitted kitchen, a spacious dining area & living room. Adjacent to the kitchen is a handy utility area leading down into the fantastic conservatory/craft room. Outside, the generously sized private rear garden is a true gem, offering a secluded oasis for alfresco dining or simply relaxing amidst the lush greenery. Upstairs you'll find a wonderful four piece family bathroom and two double bedrooms, both with walk-in wardrobes! Other highlights include, off-road parking for two vehicles, a single garage, owned solar panels, a cellar & more!

Key Features

- Freehold - Council Tax Band C - EPC TBC
- Breathtaking River & Countryside Views
- Spacious Open-plan Kitchen/Lounge/ Diner
- Beautiful Private Rear Garden
- Walking Distance To Town Centre & Amenities
- Four Double Versatile Bedrooms
- Downstairs Shower Room & 4 Piece Bathroom
- Fabulous Conservatory/Craft Room
- Single Garage & Off Road Parking For Two Vehicles
- Owned Solar Panels

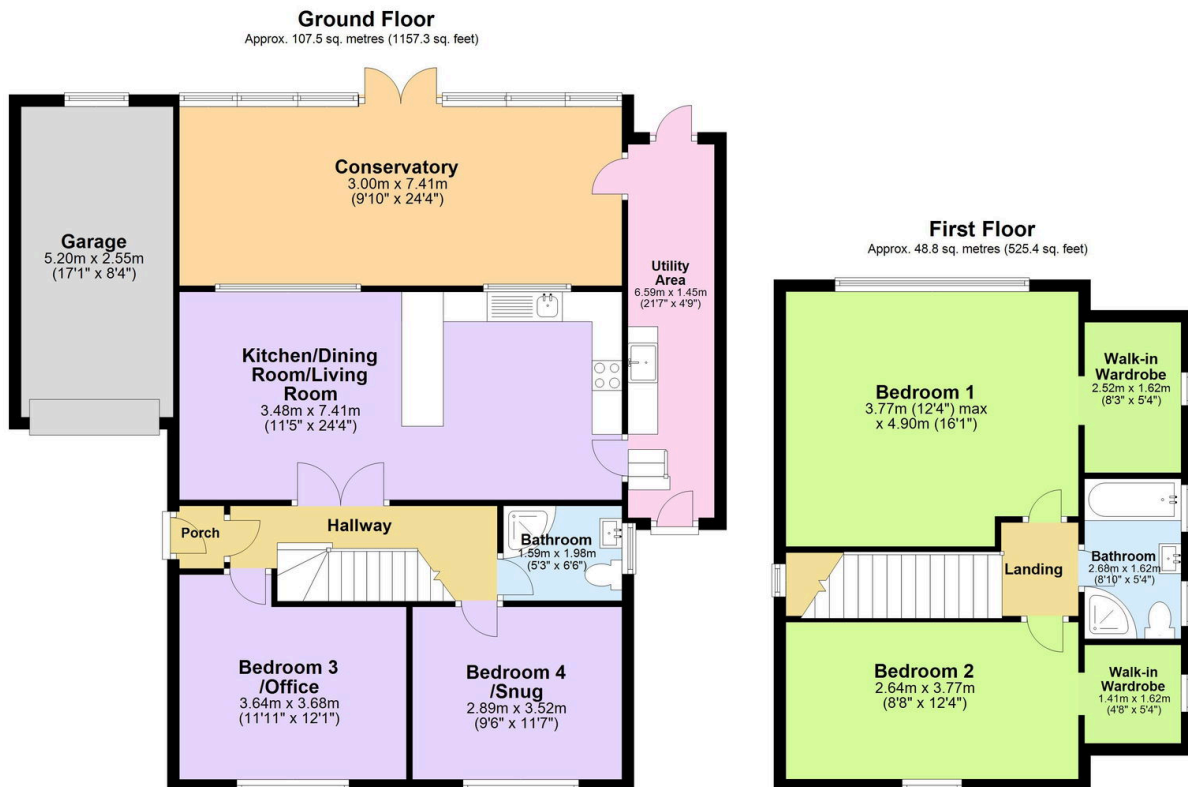

Total area: approx. 156.3 sq. metres (1682.8 sq. feet)