

Aquarius Drive, Sherford

Guide Price £475,000

🛏 5 🚗 5 🚗 1



- Semi detached six bedroom home
- L-shaped fitted kitchen
- Three ensuites
- Landscaped rear garden
- Downstairs cloakroom
- Three floors of living space
- Cosy lounge
- Luxurious family bathroom
- Single garage & parking
- To arrange a viewing, please quote VB0375



Approx Gross Internal Area
173 sq m / 1859 sq ft



Ground Floor
Approx 56 sq m / 602 sq ft

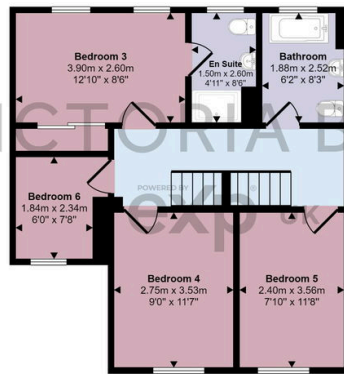

First Floor
Approx 57 sq m / 609 sq ft

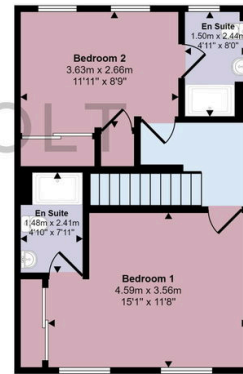

Second Floor
Approx 43 sq m / 468 sq ft

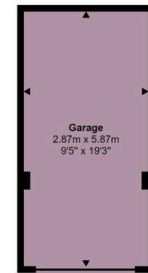

Garage
Approx 17 sq m / 181 sq ft

This floorplan is only for illustrative purposes and is not to scale. Measurements of rooms, doors, windows, and any items are approximate and no responsibility is taken for any error, omission or mis-statement. Icons of items such as bathroom suites are representations only and may not look like the real items. Made with Made Snazzy 360.

To arrange a viewing, please quote VB0375. This spacious six-bedroom family home in Sherford, Plymouth, offers modern living across three floors. The ground floor includes a cosy lounge, a cloakroom, and an L-shaped kitchen with integrated appliances, dining space, and access to a landscaped rear garden. The first floor features three double bedrooms (one with an ensuite and built-in wardrobe), a single bedroom/study, and a family bathroom. The second floor provides two large double bedrooms, each with ensuite and scenic views. The property also benefits from a single garage, accessible via the garden, with patio, lawn, and decking areas.