



VICTORIA BOLT

POWERED BY  
**exp**™ UK

@ victoria.bolt@exp.uk.com

🌐 victoriabolt.exp.uk.com

📞 07415 758 109

Elm Park, Ivybridge  
Guide Price £279,950

3 3 1



- Three-bedroom semi-detached family home
- Built in 2022
- Storage cupboard in the kitchen
- Master bedroom with en suite
- Driveway parking for two cars
- To arrange a viewing, please quote VB0375.
- Modern open-plan kitchen/dining room
- Downstairs toilet
- Low-maintenance, Westerly facing garden with patio and lawn
- 0.3 mile to Ivybridge Train Station



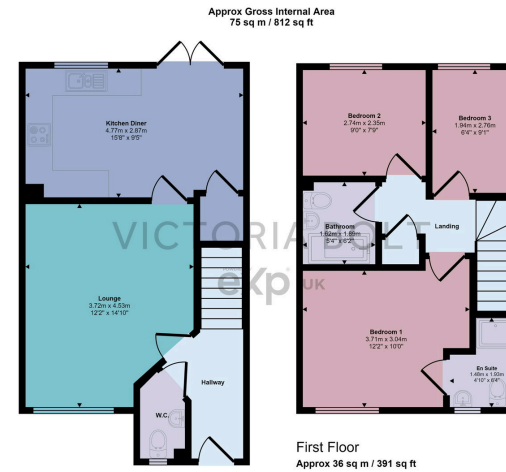

This floorplan is only for illustrative purposes and is not to scale. Measurements of rooms, doors, windows, and any items are approximate and no responsibility is taken for any error, omission or mis-statement. Icons of items such as bathroom suites are representations only and may not look like the real items. Made with Made Snappy 360.

Charming three-bedroom semi-detached house in Ivybridge, built in 2022 and finished to a high standard. Features include a spacious lounge, modern open-plan kitchen/dining room, master bedroom with en suite, and low-maintenance garden. It is ideal for families and professionals, with driveway parking for two cars. To arrange a viewing, please quote VB0375.

