

Risdon Drive, Ivybridge

Guide Price £210,000

🛏️ 2 🚿 1 🚗 1



To arrange a viewing, please quote VB0375. Charming two-bedroom semi-detached house in Ivybridge's sought-after Woodlands area. Features include an open-plan recently refitted kitchen/ diner and lounge, modern fully tiled bathroom, and spacious bedrooms. The generous back garden boasts a wooden decking, lush lawn, and gravelled area. Two parking spaces and side access complete this ideal first home.

Key Features

- Two-bedroom semi-detached home
- Open-plan layout
- To arrange a viewing, please quote VB0375
- Recently refitted kitchen
- Fully tiled bathroom with contemporary fixtures and fittings that has recently been refitted
- Generous back garden with wooden decking, lush lawn, and gravelled area
- Convenient off-street parking
- Easy access to the rear garden by a side gate
- An excellent opportunity for those entering the property market
- Short chain

Approx Gross Internal Area
49 sq m / 531 sq ft

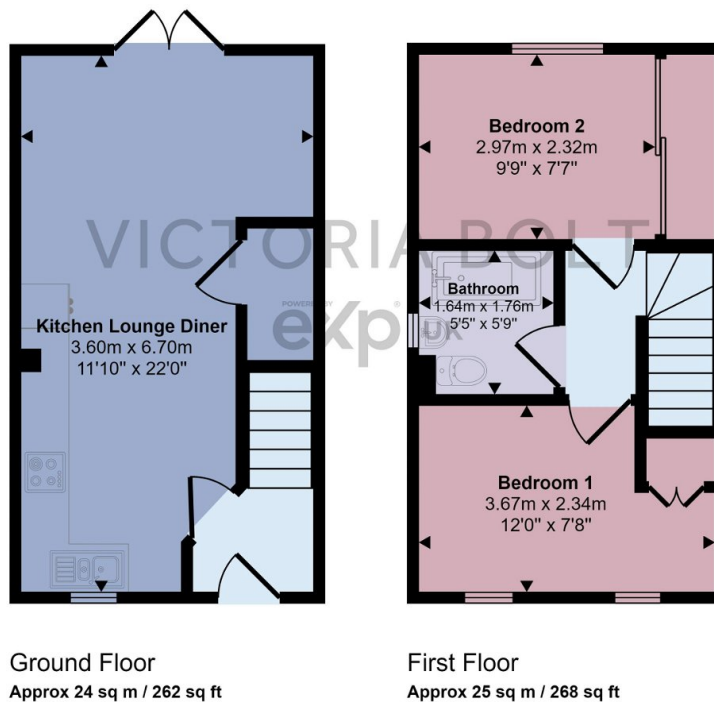

This floorplan is only for illustrative purposes and is not to scale. Measurements of rooms, doors, windows, and any items are approximate and no responsibility is taken for any error, omission or mis-statement. Icons of items such as bathroom suites are representations only and may not look like the real items. Made with Made Snappy 360.