

## Coombe Way, Plymouth

Guide Price £210,000

🛏 3 🚿 1 🚗 1



To arrange a viewing, please quote VB0375. This charming three-bedroom end-of-terrace house is in a peaceful Plymouth area. It features neutral decor, a bright living room, a spacious kitchen/diner, a modern bathroom, a low-maintenance garden, a driveway, and allocated parking spaces. Perfect for families.

## Key Features

- End-of-terrace three bedroom house
- Neutral decor throughout
- Modern family bathroom
- Low-maintenance garden
- Located in lovely residential area of Plymouth
- Three generously sized bedrooms(2dbs; 1sng)
- Spacious and luminous living areas
- Airing cupboard for extra storage
- Driveway and two allocated parking spaces nearby
- To arrange a viewing, please quote VB0375.

Approx Gross Internal Area  
75 sq m / 802 sq ft

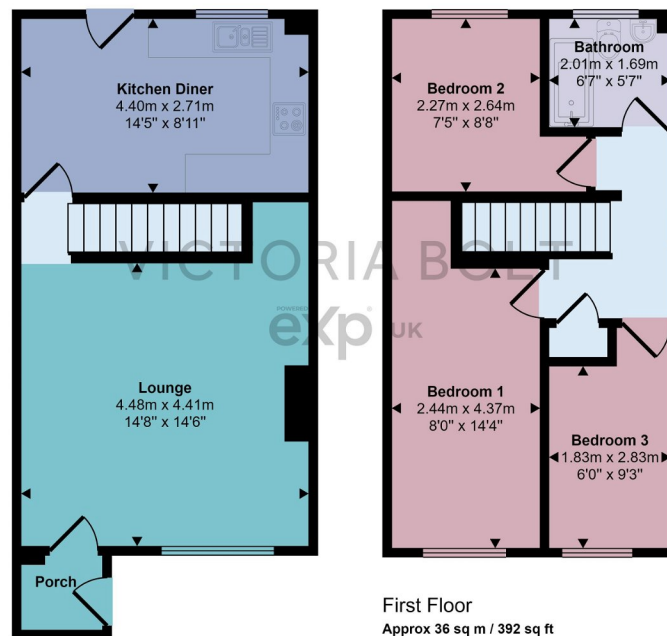

Ground Floor  
Approx 38 sq m / 411 sq ft

First Floor  
Approx 36 sq m / 392 sq ft

This floorplan is only for illustrative purposes and is not to scale. Measurements of rooms, doors, windows, and any items are approximate and no responsibility is taken for any error, omission or mis-statement. Icons of items such as bathroom suites are representations only and may not look like the real items. Made with Made Snappy 360.