

## Hockin Close, Kelly Bray, Callington

Offers In Region Of £410,000

4 2 3



As you step inside the welcoming entrance hall, you're enveloped in a feeling of openness and charmed by its light and airy atmosphere. The spacious living room boasts large windows & patio doors that floods the room with natural light. The stylish modern kitchen is generously sized and flows into a wonderful snug/breakfast room with patio doors leading into the garden. Upstairs, you'll find four well-proportioned bedrooms, including a spacious en-suite shower room and modern family bathroom. Outside, the private rear garden is a true gem, offering a secluded oasis for alfresco dining, entertaining, or simply relaxing amidst the lush greenery. Other highlights include a double garage, off-road parking for multiple vehicles, separate dining room, handy downstairs wc and a utility room!

## Key Features

- Freehold - Council Tax Band E - EPC C
- Fabulous Detached Family Home
- Four Good-Sized Bedrooms
- En-suite Shower Room
- Spacious Living Room
- Separate Dining Room
- Stylish Kitchen & Snug Room
- Utility Room
- Double Garage & Off-Road Parking For Multiple Vehicles
- Quote BH0675 To Book Your Viewing

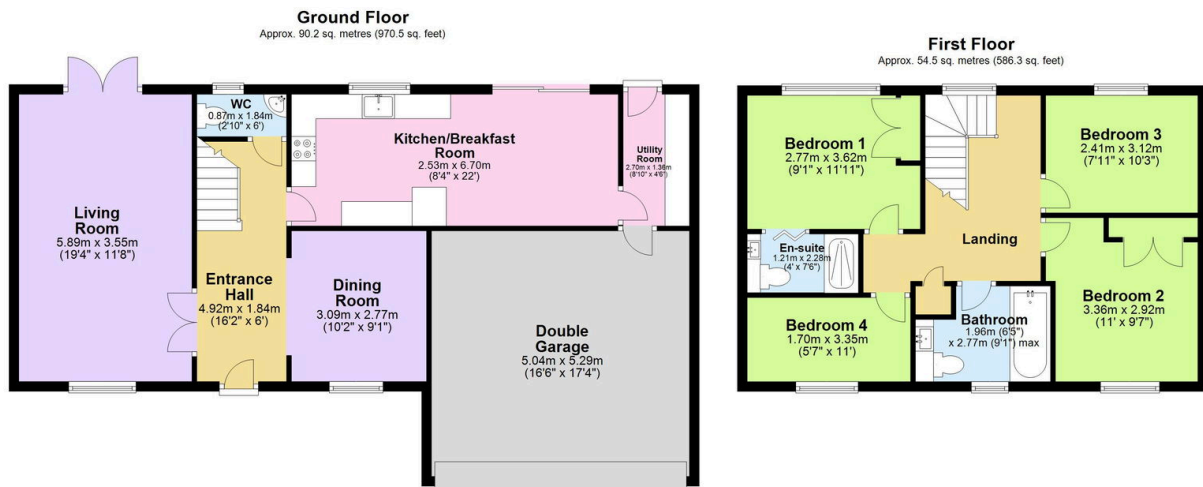

Total area: approx. 144.6 sq. metres (1556.8 sq. feet)