

Lady Beam Court, Kelly Bray, Callington

Guide Price £220,000

3 2 1

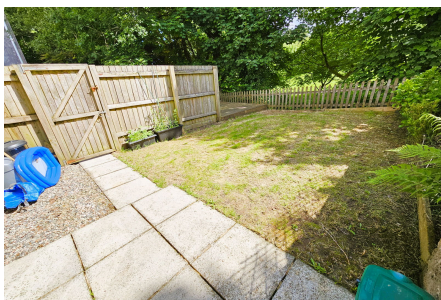

Step inside and be greeted by a warm and inviting atmosphere, with a spacious living room boasting a large window that floods the space with natural light. The kitchen/diner is generously sized with patio doors proving a seamless flow into the garden. Upstairs, you'll find three well-proportioned bedrooms, including a spacious en-suite shower room and modern family bathroom. Outside, the private rear garden is a true gem, offering a secluded oasis for alfresco dining, entertaining, or simply relaxing amidst the lush greenery. Other highlights include a single garage with two off-road parking spaces, handy downstairs wc and two large storage cupboards. This wonderful home is ideally situated within a short distance of excellent schools, parks, and local amenities.

Key Features

- Freehold - Council Tax Band C - EPC C
- NO ONWARD CHAIN!
- Fantastic End of Terrace Home
- Three Good-Sized Bedrooms
- En-Suite Shower Room
- Spacious Living Room & Kitchen/Diner
- Downstairs WC
- Modern Family Bathroom
- Garage & Off Road Parking For Two Vehicles
- Quote BH0675 To Book Your Viewing

Ground Floor

Approx. 37.7 sq. metres (405.3 sq. feet)

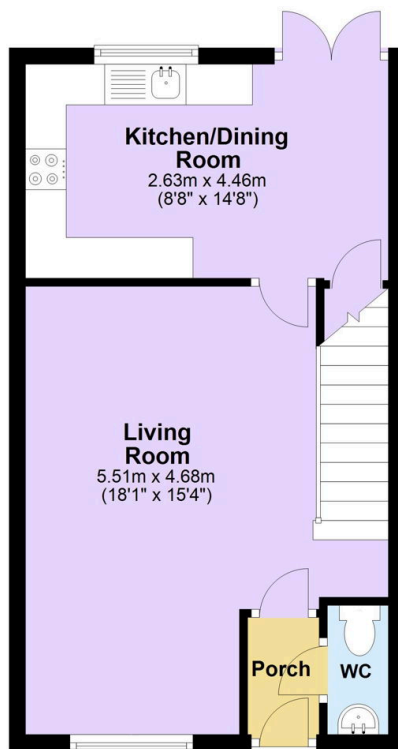

First Floor

Approx. 36.6 sq. metres (393.7 sq. feet)

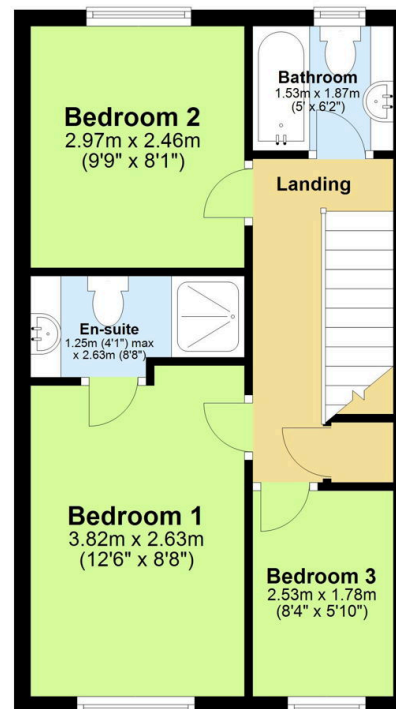

Total area: approx. 74.2 sq. metres (799.0 sq. feet)