



ZAFER CETINEL POWERED BY **exp** TM UK

@ zafer.cetinel@exp.uk.com

zafercetinel.exp.uk.com

01242 374 844



# Moonstone Grove, Bishops Cleeve, Cheltenham, GL52 7ZE

Guide Price £275,000

3 2 1





Introducing a modern three-bedroom house located in the picturesque village of Bishops Cleeve. This contemporary property is spread across three floors, offering space and comfort for a family.

On the ground floor, you will find an inviting entrance hall leading to an open plan lounge diner kitchen. The living room features patio doors that open into the rear garden, allowing natural light to fill the space. Additionally, there are windows to the front and a convenient downstairs toilet on this floor.

Moving up to the first floor, you will discover two well-appointed bedrooms and a stylish bathroom.

Ascending to the top floor, the property boasts a spacious master bedroom, providing a private retreat with panoramic views of the surroundings.

Notable features of this property include double glazing for energy efficiency, gas-fired central heating for comfort, and solar panels for sustainable living. Property also benefits with New Home Buyers Guarantee for another two more years.

This modern build property in Bishops Cleeve village is a perfect blend of style, functionality, and eco-conscious design, offering a comfortable and inviting living space for its residents.

## OUTSIDE

Outside, the property offers a front garden and parking space for two cars, complete with an EV charging point for eco-friendly convenience. The rear garden is, featuring a patio area, a lush lawn, a shed for storage, and gated rear access for added convenience.

## LOCATION

Bishops Cleeve is a charming village located in the Cotswold district of Gloucestershire, near the town of Cheltenham. Here are some key points that can be used for marketing and highlighting the benefits of living in Bishops Cleeve village:

Picturesque Setting: Bishops Cleeve village offers a picturesque



GROUND FLOOR  
296 sq.ft. (27.5 sq.m.) approx.

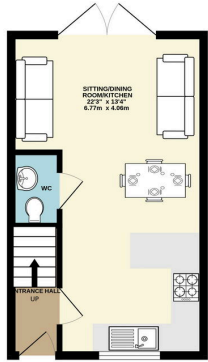

1ST FLOOR  
296 sq.ft. (27.5 sq.m.) approx.

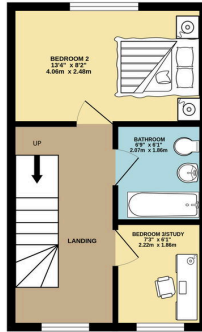

2ND FLOOR  
208 sq.ft. (19.3 sq.m.) approx.

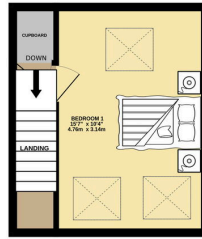

TOTAL FLOOR AREA - 799 sq.ft. (74.3 sq.m.) approx.

Whilst every attempt has been made to ensure the accuracy of the floorplan contained here, measurements of doors, windows, rooms and any other items are approximate and no responsibility is taken for any error, omission or mis-statement. This plan is for illustrative purposes only and should be used as such by any prospective purchaser. The services, systems and appliances shown have not been tested and no guarantee as to their operability or efficiency can be given.  
Made with Metropo ©2021

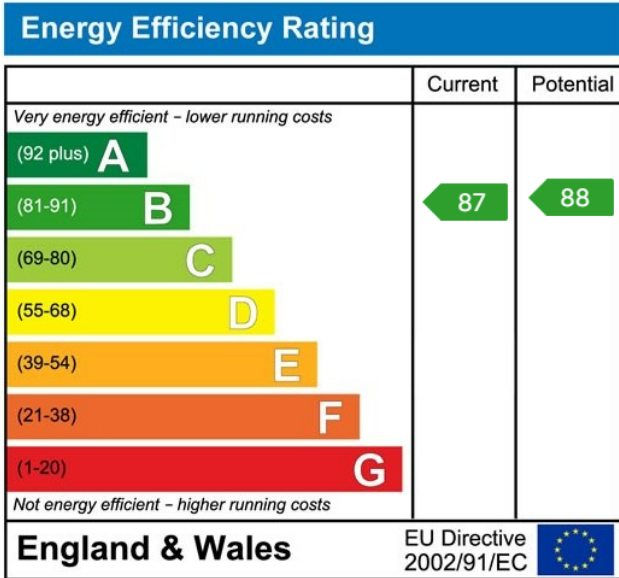

eXp World UK Ltd is a registered company at Level 37, 25 Canada Square, London, E14 5LQ.

Registered company number is 12016573. VAT Registration Number is 327 4120 29