



VICTORIA BOLT

POWERED BY
exp™ UK

@ victoria.bolt@exp.uk.com

🌐 victoriabolt.exp.uk.com

📞 07415 758 109

Moorhaven, Ivybridge

Guide Price £350,000

🛏️ 2 🚿 2 🚗 1



- Level bungalow in the village of Moorhaven
- Lounge with feature fireplace
- Two double bedrooms
- 'Jack and Jill' shower room
- Parking for three cars
- To arrange a viewing, please quote VB0375
- Kitchen/diner with integral appliances
- Master ensuite
- Immaculate attached garden
- Detached garden a short walk away, perfect for an allotment



To arrange a viewing, please quote VB0375. This well-presented bungalow is situated in the village of Moorhaven, close to Ivybridge. The accommodation comprises a lounge with a fireplace, a good-sized kitchen/diner with integral appliances, and a range cooker. There are two double bedrooms, with the master having an ensuite and the second with a 'Jack and Jill' shower room. The property offers a level garden and three parking spaces next to the property. A short walk away is a detached garden with many uses, including an allotment.



Approx Gross Internal Area
71 sq m / 767 sq ft

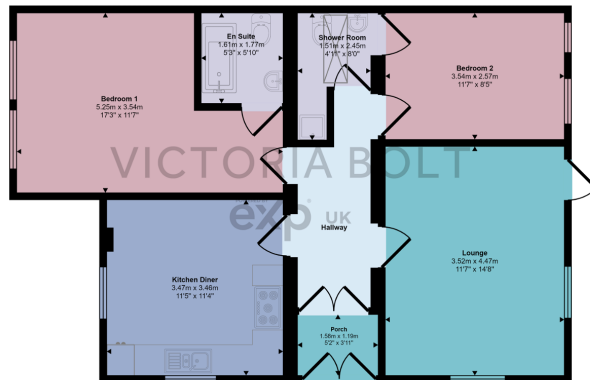

Floorplan

This floorplan is only for illustrative purposes and is not to scale. Measurements of rooms, doors, windows, and any items are approximate and no responsibility is taken for any error, omission or mis-statement. Icons of items such as bathroom suites are representations only and may not look like the real items. Made with Made Snappy 360.

