



ADAM HALLIWELL POWERED BY **exp** TM UK

@ adam.halliwell@exp.uk.com

adamhalliwell.exp.uk.com

01242 906 586

Upper Park Street, Cheltenham, GL52

£250,000

🛏️ 2 🚿 1 🚻 1



- Please quote ref AH0137
- Recently renovated with striking pink exterior
- No onward chain
- Generous 45' x 12' rear garden
- Short walk to High Street amenities
- New Kitchen
- New ground floor Bathroom
- Cul de sac location
- Two double bedrooms
- Council tax band B



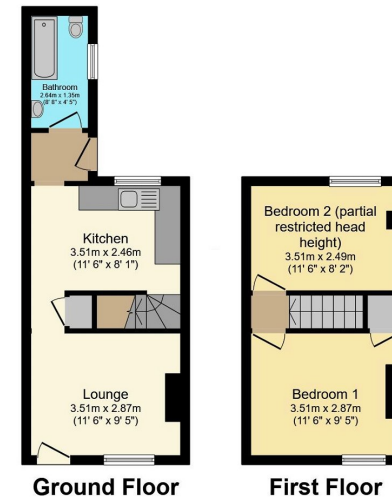

Total floor area 49.7 m² (535 sq.ft.) approx
 This plan is for illustration purposes only and may not be representative of the property. Plan not to scale. Powered by PropertyBox

This immaculate terraced property in a quiet cul-de-sac, just half a mile from the town centre, offers stylish living with a striking pink exterior, newly refurbished kitchen and bathroom, and a generous rear garden. Two double bedrooms and sold with no onward chain. Call now for more details.

Score	Energy rating	Current	Potential
92+	A		
81-91	B		88 B
69-80	C		
55-68	D	67 D	
39-54	E		
21-38	F		
1-20	G		