

Abbot Road, Ivybridge

Guide Price £305,000

🛏️ 3 🚿 2 🚻 1



To arrange a viewing, please quote VB0375. This detached house is situated on the Western side of Ivybridge, a short walk from Woodlands Park Primary School. The accommodation comprises a lounge, dining room, modern kitchen, downstairs WC, three bedrooms(2dbls;1 sng) and a recently refitted shower room. There is driveway parking and a garage.

Key Features

- Detached house
- Lounge & Dining Room
- Three Bedrooms (2 doubles;1 single)
- Good sized rear garden
- Driveway parking
- To arrange a viewing, please quote VB0375
- Kitchen with integrated appliances
- Modern shower room
- Integral garage
- Close to Woodlands Park Primary School

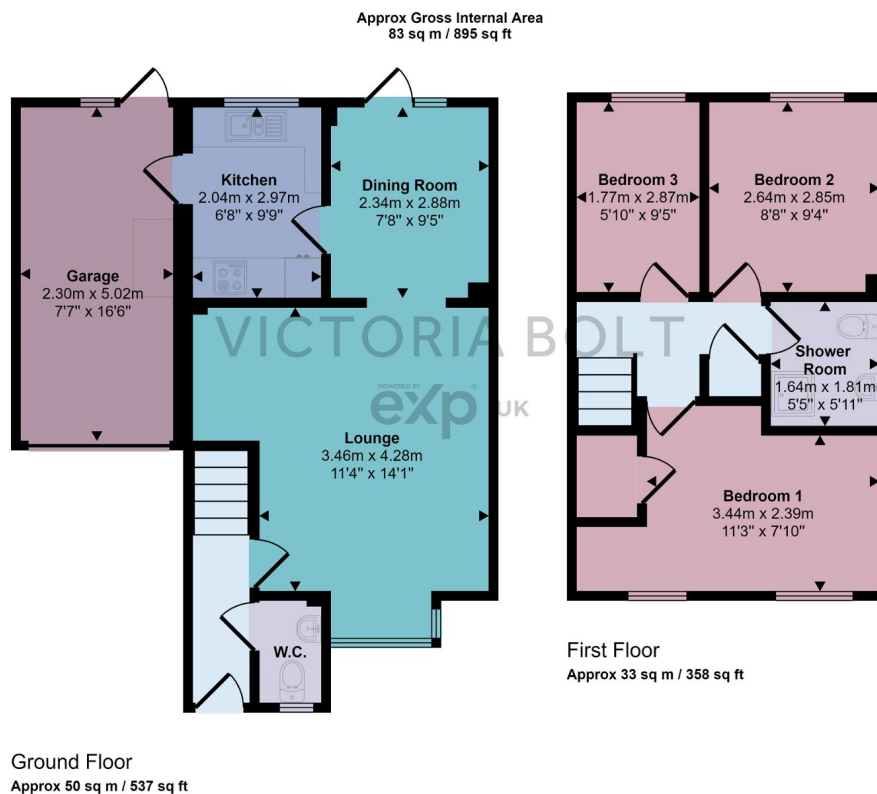

This floorplan is only for illustrative purposes and is not to scale. Measurements of rooms, doors, windows, and any items are approximate and no responsibility is taken for any error, omission or mis-statement. Icons of items such as bathroom suites are representations only and may not look like the real items. Made with Made Snappy 360.