



MELANIE LEWIS

exp<sup>®</sup> UK

@melanie.lewis@exp.uk.com

melanielewis.exp.uk.com

07846 64 64 58

# Tadley Meadow, Frome, Somerset, BA11 4FL

Offers Over £725,000

4 3 2



- Please quote reference number MJ0484 to book your appointment at our next Open 2000 on 23rd September
- 4 bedrooms
- Further ensuite and family bathroom with bath and separate rainfall shower
- Freehold
- Semi-rural setting with views over open countryside
- 28 foot high spec kitchen
- Master Bedroom Suite of dressing area and ensuite shower room
- Double garage with electric door and extensive driveway parking
- Close to highly rated Primary School



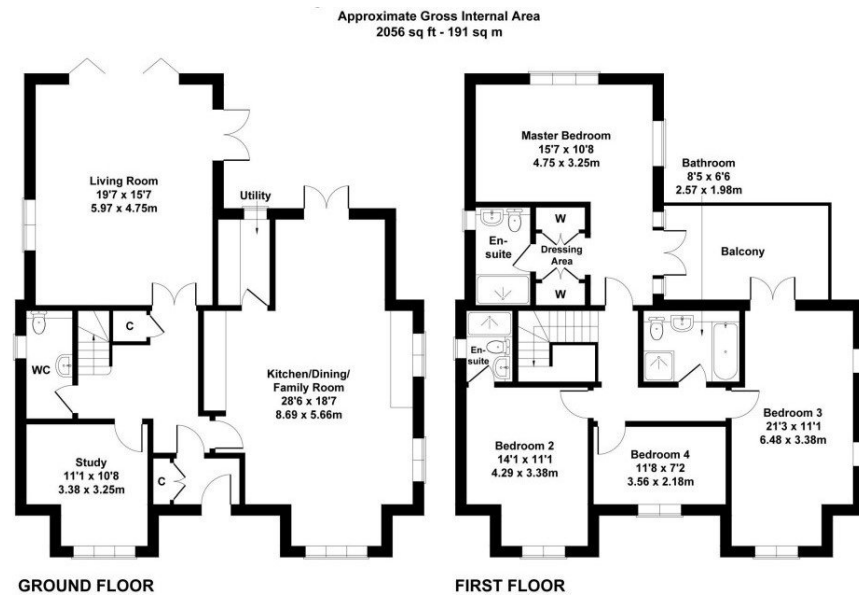

Please quote Ref: MJ0484 when making an enquiry

If you are looking for the perfect mix of open countryside and easy access to the town centre, this lovely detached home in Tadley Meadow, on the periphery of Frome, will deliver just that. With the pretty village of Nunney, with its river, castle and cosy cafe only 2 miles away, views over open countryside from the back garden and the centre of Frome just over 1 mile away you really do have the best of both worlds.

Whether you need a spacious family home or are thinking of downsizing but still need room for the grandchildren this is the house for you.

Score	Energy rating	Current	Potential
92+	A		
81-91	B	85 B	91 B
69-80	C		
55-68	D		
39-54	E		
21-38	F		
1-20	G		