



NATHAN LITTLEBOY

POWERED BY
exp™ UK

@ nathan.littleboy@exp.uk.com

nathanlittleboy.exp.uk.com

07880 496 470

Bright Street, Kingswood, Bristol, BS15 8NE

Guide Price £160,000

🛏 1 🚿 1 🚗 1



- Ground Floor One Double Bedroom
- Modern Kitchen And Bathroom
- Gas Central Heating
- Leasehold - 125 Years Commencing 24 April 2006
- Existing Tenant Would Like To Stay If Possible
- One Allocated Parking Space
- Double Glazed
- Only 400m To Kingswood High Street
- Vacant Purchase Or Potential Investment
- Ref:NL0321



This ground floor double bedroom apartment is set within easy reach of Kingswood High Street where a wide and varied selection of shops, pubs and restaurants can be found. There is convenient access to local public transport into Bristol City Centre and by car to the ring road leading to Keynsham, Bath and North Bristol.

Accommodation includes a secured communal entrance which leads to two ground floor apartments, as well as stairs to the first floor. Once inside the apartment itself, a central inner hall provides access to all rooms. The living, dining and kitchen area is to the rear of the property, whilst the double bedroom and a bathroom are to the front. This super apartment benefits from having modern kitchen and bathrooms, double glazing throughout and a gas central heating system. Outside there is an allocated parking space to the rear of the property.



GROUND FLOOR
374 sq.ft. (34.7 sq.m.) approx.

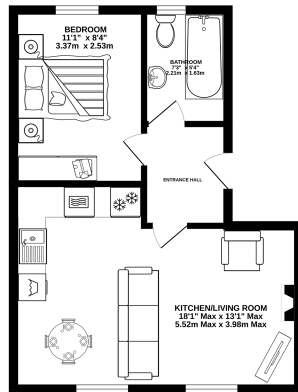

TOTAL FLOOR AREA: 374 sq.ft. (34.7 sq.m.) approx.
Whilst every attempt has been made to ensure the accuracy of the floorplan, the information is provided as a guide only. The floorplan is not intended to be used as a basis for any contractual obligations. The floorplan is not intended to be used as a basis for any contractual obligations. The floorplan is not intended to be used as a basis for any contractual obligations.

