

Smithaleigh, Plympton

Guide Price £650,000

🛏 5 🚪 3 🚿 1



- Detached farmhouse in Smithaleigh
- No onward chain
- Lounge with feature fireplace and woodburner
- Spacious kitchen/diner
- Study/playroom/bedroom 6
- Downstairs WC
- Five double bedrooms
- Family bathroom
- Ensuite to the master bedroom with a small dressing area
- Driveway parking for multiple vehicles and a garden

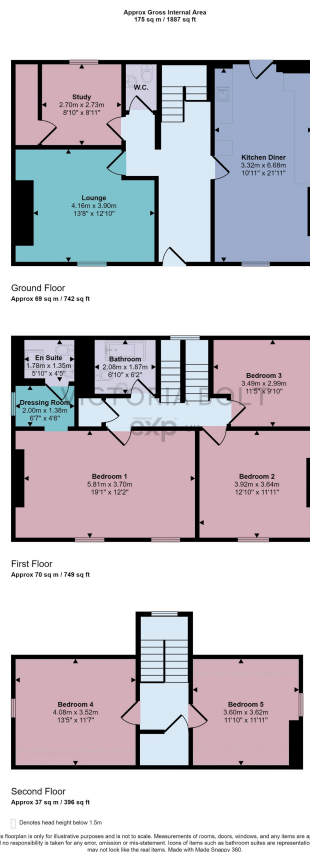

This detached farmhouse is situated in a convenient location in Smithaleigh near Plympton. The property has been thoughtfully renovated to a high standard throughout. The accommodation comprises a lounge, kitchen/diner, study and a downstairs WC. Upstairs, there are five bedrooms arranged over two floors. The master bedroom has a small dressing area and an ensuite shower room. There is a family bathroom with a rolltop bath. Outside, there is a garden and driveway parking. The property is full of character and charm and is offered for sale with no onward chain.