

Carbona Close, Callington, PL17

Guide Price £325,000

3 bedrooms 2 bathrooms 1 garage



A double-fronted detached family home situated on a private road within the ever popular Meadowbrook development. This modern property benefits from three bedrooms, two bathrooms and a private garage.

Callington is a charming Cornish town located within a prime location in South East Cornwall and just 15 miles from Plymouth City Centre. The Town benefits from a range of facilities including a health centre, sports centre/gym, supermarkets, church and both primary and secondary schools. The area provides some idyllic countryside walks with Cotehele estate and house, Kit Hill and the Tamar Valley all nearby making it an ideal place for families and individuals alike.

Key Features

- TO ARRANGE A VIEWING PLEASE QUOTE BL0650
- Three Bedrooms
- Garage
- Popular Modern Development
- Kitchen/Dining Room
- Detached
- Private Road
- Beautifully Presented
- Two Bathrooms
- Freehold

Carbona Close, Callington, PL17

Approximate Area = 970 sq ft / 90.1 sq m
Garage = 222 sq ft / 20.6 sq m
Total = 1192 sq ft / 110.7 sq m

For identification only - Not to scale

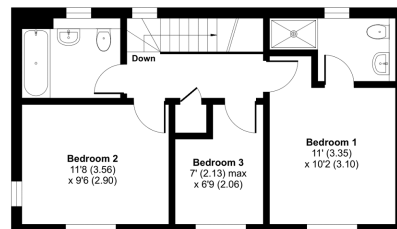
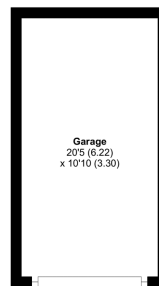

FIRST FLOOR

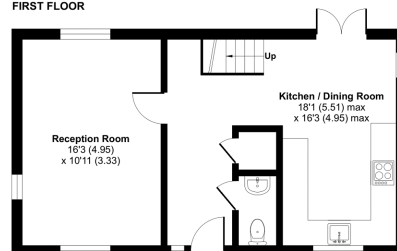

GROUND FLOOR



Floor plan produced in accordance with RICS Property Measurement Standards incorporating International Property Measurement Standards (IPMS2 Residential). © richiecom 2023. Produced for Ben Estates TA Ben Langton Powered By exp. REF: 1069652