



SIMON THOMPSON

exp<sup>®</sup> UK

@ [simon.thompson@exp.uk.com](mailto:simon.thompson@exp.uk.com)

[simonthompson.exp.uk.com](https://www.simonthompson.exp.uk.com)

📞 07879 656 288

# Gambet Road, Brockworth, Gloucester, GL3 4SF

£375,000

🛏️ 4 🚿 3 🛋️ 2



- Well presented four bedroom semi detached house in popular Coopers Edge
- En-suite and built-in wardrobes in master bedroom
- Garage and driveway
- Spacious open-plan kitchen / diner with island and doors out to the garden
- Separate living room with French doors out to the garden
- Gas central heating and double glazing
- Kitchen with a full range of integrated appliances
- Property Ref - ST0728



Introducing a fantastic Four Bedroom semi detached house in ever popular Coopers Edge. With large Kitchen / diner boasting a full range of integrated appliances and separate living room, both with French doors onto the garden this property makes a fantastic family home. Four well proportioned bedrooms with the master boasting en-suite and built in wardrobes are on the first floor.

Externally there is a driveway leading to the single garage and an enclosed private rear garden.

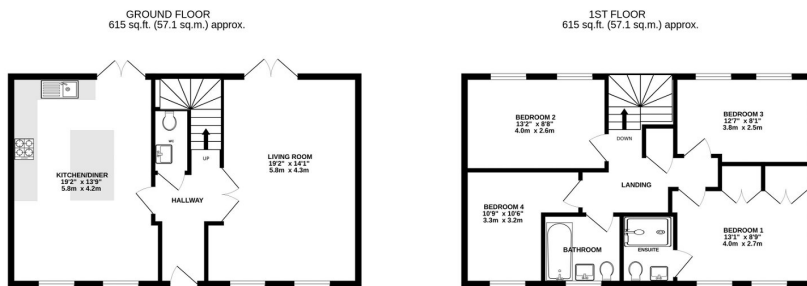

TOTAL FLOOR AREA: 1230 sq ft. (114.3 sq.m.) approx.  
 Whilst every attempt has been made to ensure the accuracy of the floorplan contained here, measurements of doors, windows, rooms and any other items are approximate and no responsibility is taken for any error, omission or mis-statement. This plan is for illustrative purposes only and should be used as such for any prospective purchaser. The services, systems and appliances shown have not been tested and no guarantee as to their operability or efficiency can be given.  
 Made with Metrepro ©2023

