



VICTORIA BOLT

POWERED BY
exp™ UK

@ victoria.bolt@exp.uk.com

🌐 victoriabolt.exp.uk.com

📞 07415 758 109

New Meadow, Ivybridge

Guide Price £450,000

3 2 1



Nestled in a peaceful cul-de-sac on the Western side of Ivybridge is this beautiful detached bungalow which offers the perfect blend of comfort, style, and privacy. You enter the bungalow into a generous hallway that gives access to all the rooms. The good size lounge is the ideal space for gathering with friends and loved ones. Adjacent to the lounge, a charming conservatory beckons, providing a serene spot to relax and immerse yourself in the tranquility of the surrounding nature.

There is a modern kitchen with ample countertop space and storage. There is an integral double oven, hob and washing machine. There is also plenty of space for a breakfast table.

This versatile property offers two or three bedrooms, providing the flexibility you desire. The master bedroom boasts an ensuite and two fitted wardrobes. Meanwhile, the third bedroom can easily transform into a delightful dining area, perfect for hosting memorable dinner parties or intimate gatherings. The second double bedroom also has a fitted wardrobe.

As you step outside from the kitchen or the conservatory, a private garden awaits. Bask in the sun or host alfresco brunches, or simply enjoy a morning cup of coffee in the peaceful surroundings. From the top of the garden a seating area gives the most fantastic views over Ivybridge and towards the South Hams.

Convenience meets practicality with a garage and driveway parking for 3 to 4 cars, ensuring you never have to worry about finding a spot. As for the surrounding area, enjoy the benefits of a cul-de-sac location, where peace and quiet reign supreme, and the hustle and bustle of the outside world feels miles away.

Don't miss the opportunity to make this detached bungalow your own sanctuary. Embrace the tranquility, revel in the modern amenities, and create cherished memories in this delightful haven. To arrange a viewing today please quote VB0375.



15 New Meadow, Ivybridge

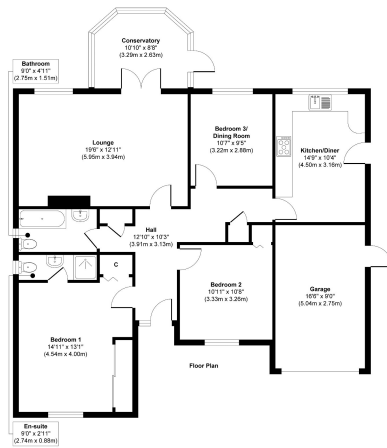

Approx. Gross Internal Floor Area 1084 sq. ft./ 100.76 sq. m
 *Measurements for information purposes only, measurements are approximate, not to scale.
 Produced by Elements Property

- Detached bungalow on the Western side of Ivybridge
- To arrange a viewing, please quote VB0375
- Lounge & conservatory
- Modern kitchen/breakfast room
- Three good size bedrooms
- Master ensuite & separate bathroom
- Third bedroom could be a dining room
- Private corner plot garden
- Driveway parking for 3/4 cars & a garage
- Walking distance to bus stop and the local shop

