

The Green, Lower Burraton, Saltash

Guide Price £166,500

🛏 2 🚿 1 🚗 1



NO ONWARD CHAIN! This wonderful two bedroom home is situated in the highly popular Lower Burraton area of Saltash and would make a fantastic **FIRST TIME BUY** or **INVESTMENT**. The property overlooks The Green and is only a short walk from Burraton Primary School, the local Spar shop and other amenities. The property also benefits from easy access to the A38 & A388 along with local transport links. Other features include; rear garden, lounge/diner, modern kitchen, family bathroom, single garage in a near-by block easily accessed from the garden, GCH & more! Viewings are highly recommended, call today to book your appointment!

Quote BH0675 To Book A Viewing

Key Features

- Quote BH0675 To Book A Viewing
- Two Bedroom Mid Terrace
- Lounge/Diner
- Popular Location
- Modern Kitchen
- Freehold - EPC D - Council Tax Band B
- Garage In A Block At The End Of The Garden
- Close To Schools & Amenities
- Fantastic First Time Buy or Investment
- NO ONWARD CHAIN

Ground Floor

Approx. 28.1 sq. metres (302.3 sq. feet)



First Floor

Approx. 27.5 sq. metres (296.4 sq. feet)

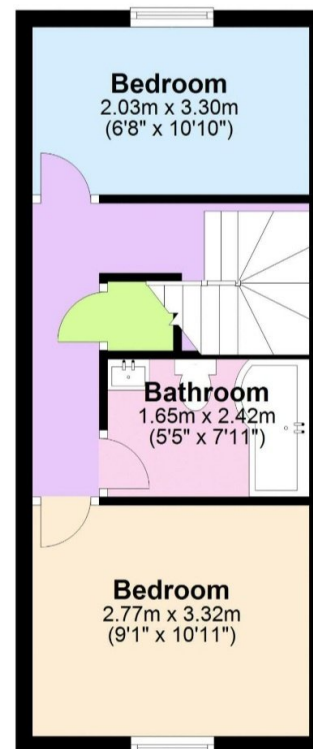

Total area: approx. 55.6 sq. metres (598.7 sq. feet)