

9 The Green, Saltash, PL12 4SQ

Guide Price £170,000



This wonderful two bedroom home is situated in the highly popular Lower Burraton area of Saltash and would make a fantastic **FIRST TIME BUY** or **INVESTMENT**. The property over looks The Green and is only a short walk from Burraton Primary School, the local Spar shop and other amenities. The property also benefits from easy access to the A38 & A388 along with local transport links. Other features include; rear garden, lounge/diner, modern kitchen, family bathroom, single garage in a near-by block easily accessed from the garden, GCH & more! Viewings are highly recommended, call today to book your appointment!

Key Features

- Freehold
- Council Tax Band B
- EPC – D
- Two Bedroom Mid-Terrace Home
- Garage in a Block at the end of the Garden
- Lounge / Diner
- Modern Kitchen
- Fantastic First Time Buy or Investment Opportunity
- Situated in the popular Lower Burraton area of Saltash
- Close to Schools, Transport Links & Amenities

Ground Floor

Approx. 28.1 sq. metres (302.3 sq. feet)

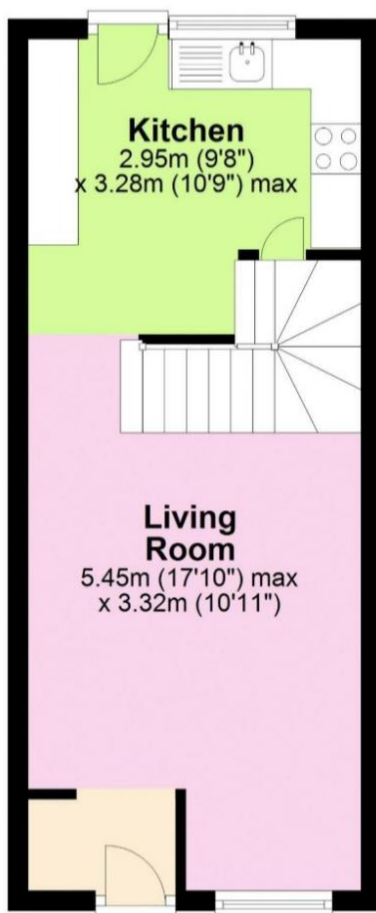

First Floor

Approx. 27.5 sq. metres (296.4 sq. feet)

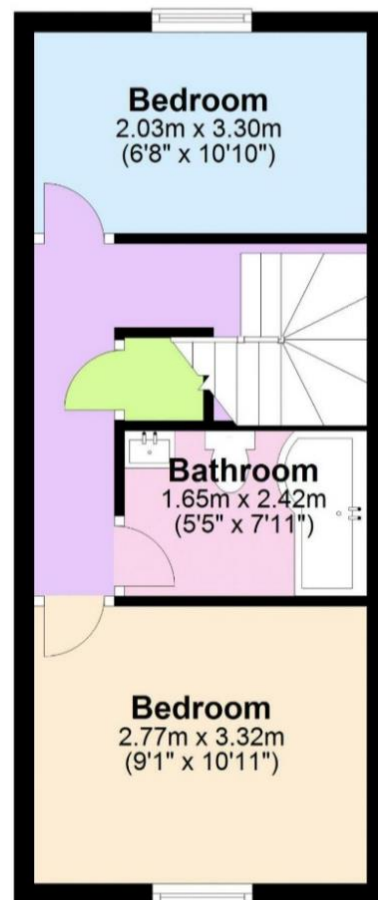

Total area: approx. 55.6 sq. metres (598.7 sq. feet)