



NICOLA LANGFORD

exp[®] UK

@ nicola.langford@exp.uk.com

🌐 nicolalangford.exp.uk.com

☎ 07396 394 255

Rothwell, Northampton, Northamptonshire, NN14 6FR

Guide Price £230,000

🛏️ 2 🚿 2 🛋️ 1



- Semi Detached
- Two Double Bedrooms
- Cloakroom
- Kitchen Dinner
- Bathroom
- Enclosed Rear Garden
- Off Road Parking for Several Vehicles
- Still Under NHBC
- Good Transport Links
- Property Ref NL1208



A well-proportioned two-bedroom, semi-detached home on the Woodland Valley development built by persimmon homes in the popular market town of Rothwell, Kettering Northamptonshire. (Property Reference NL1208)

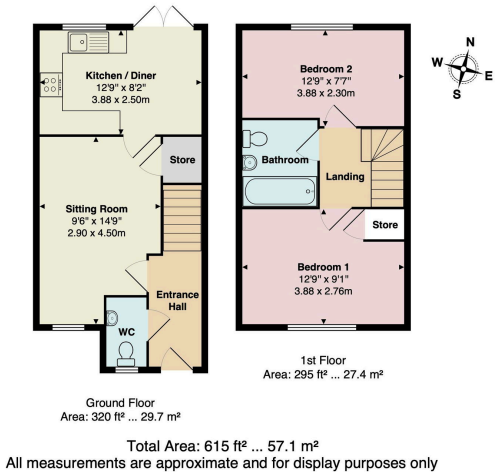

Energy rating and score

This property's energy rating is B. It has the potential to be A.

[See how to improve this property's energy efficiency.](#)

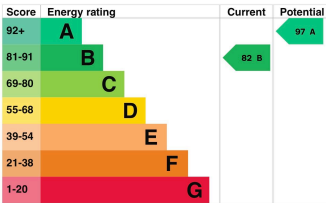

The graph shows this property's current and potential energy rating.

Properties get a rating from A (best) to G (worst) and a score. The better the rating and score, the lower your energy bills are likely to be.

For properties in England and Wales:

- the average energy rating is D
- the average energy score is 60