

## Bow Road, Watringbury, Maidstone, ME18 5DD

Guide Price £700,000

5 3 4



Welcome to this stunning four-bedroom semi-detached period home in the heart of Watringbury. Perfectly positioned for family life, the village offers beautiful countryside walks, a boating marina, well-regarded schools, and excellent transport links to Maidstone, Tonbridge, Tunbridge Wells and even London. Full of charm and character, this home combines elegant period features with versatile living spaces, a large private garden, and even a detached one-bedroom annex – making it a truly unique find.

## Key Features

- Detached one-bedroom annex with private court yard garden
- Oozes period charm throughout
- An abundance of living space
- Ground floor W/C with shower
- Large, private, sunny aspect rear garden
- Four double bedrooms with the Fifth in the annex
- Versatile basement
- I strongly advise watching the video to get a better understanding of this home
- I cannot stress enough how you need to view this home to appreciate all it offers
- Property reference: JN0505

Approximate Gross Internal Area 1896 sq ft - 176 sq m  
Annexe Internal Area 460 sq ft - 43 sq m  
Total Internal Area 2356 sq ft - 219 sq m

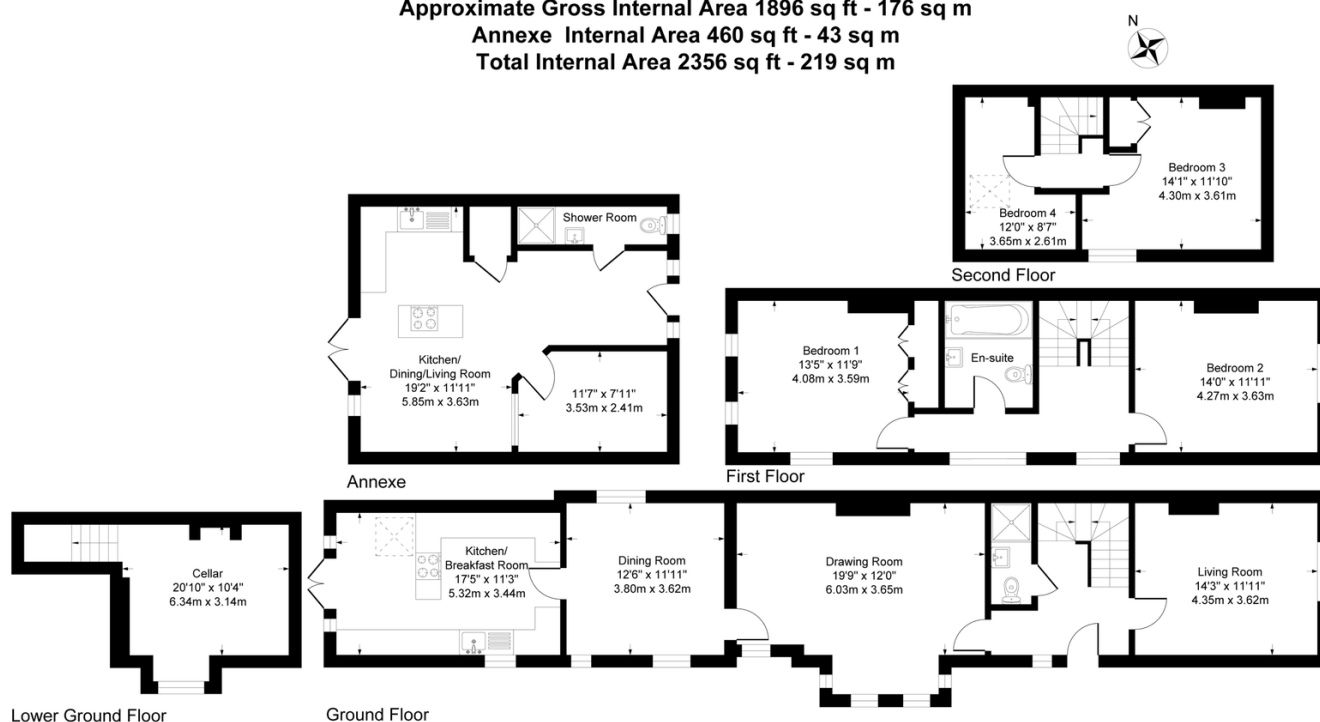

Although every attempt has been made to ensure accuracy, all measurements are approximate.  
This floorplan is for illustrative purposes only and not to scale.  
Measured in accordance with RICS Standards.