



ALISON MCCAREY POWERED BY **exp** <sup>TM</sup> UK

@ alison.mccarey@exp.uk.com

🌐 alisonmccarey.exp.uk.com

☎ 07506 730 460



# The Nurses House, Adams Walk, Midhurst , West Sussex, GU29 0FF

Guide Price £450,000

🛏 2 🍳 1 🛋 1



- 2 Bedroom ground floor apartment
- 2 allocated car parking spaces
- Premium Siemens appliances
- Private entrance
- Concierge service
- French doors to private terrace garden
- Contemporary fitted kitchen
- High specification throughout
- Estate facilities including pool & gym
- Located in the stunning South Downs National Park





This two-bedroom contemporary ground floor apartment offers a unique blend of modern luxury and natural tranquility. With its private terrace, woodland views, and access to exclusive amenities, this residence presents an unparalleled living experience in a wonderful setting.

With open plan living/dining area and contemporary fitted kitchen there is a wonderful flow to the apartment. The modern kitchen features stone worktops, Siemens premium integrated appliances and sleek storage cupboards. Both double bedrooms are carpeted, fitted with TV points and feature large character windows giving views of the terrace and the woodland trees.

The french doors open onto a lawned and patio terrace with peaceful woodland views.

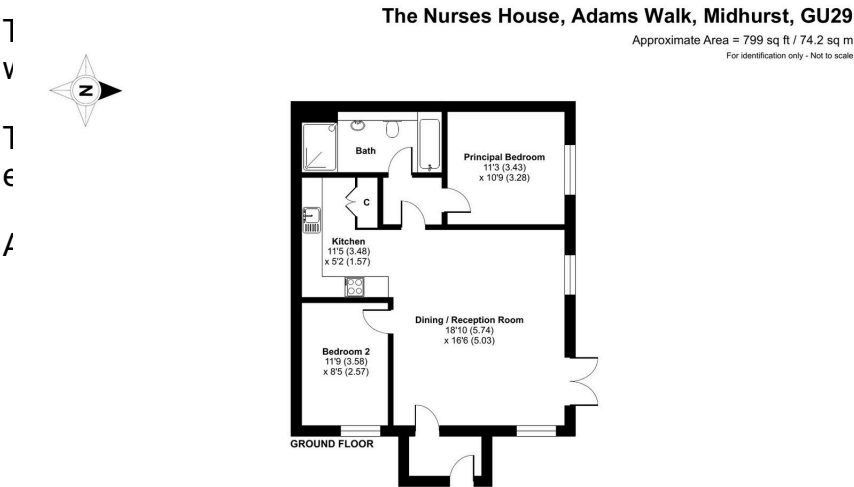

**Certified Property Measurer**  
Floor plan produced in accordance with RICS Property Measurement Standards incorporating International Property Measurement Standards (IPMS Residential), 1st edition 2023.  
Produced for Alison McCarney Ltd powered by eXp. REF: 1002637

Score	Energy rating	Current	Potential
92+	A		
81-91	B		
69-80	C	78 C	78 C
55-68	D		
39-54	E		
21-38	F		
1-20	G		

The graph shows this property's current and potential energy rating.