



JULES MIDDLETON

exp[®] UK

@ jules.middleton@exp.uk.com

🌐 julesmiddleton.exp.uk.com

☎ 07539 429 451

103 London Road,
£775,000

🛏 2 🚿 2 🛋 1



- Spacious split-level property.
- Poggenpohl kitchen, Neff appliances.
- High ceilings, lots of natural light.
- Private courtyards, communal gardens.
- No chain.
- Two double bedrooms, one with en suite.
- Wooden flooring throughout with underfloor heating.
- Secure underground parking space.
- Three separate outdoor spaces.
- Please quote JM0792 when enquiring.





A stunning modern split-level property in an award winning development within walking distance to the City Centre and mainline train station.

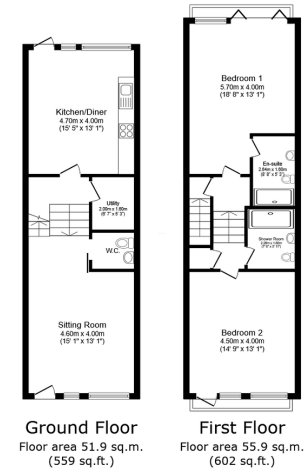

Total floor area: 107.9 sq.m. (1,161 sq.ft.)

This floor plan is for illustrative purposes only. It is not drawn to scale. Any measurements, floor areas (including any total floor area), openings and orientations are approximate. No details are guaranteed, they cannot be relied upon for any purpose and do not form any part of any agreement. No liability is taken for any error, omission or misstatement. A party must rely upon its own inspection(s). Powered by www.Propertybox.io

