

## Linden Grove, Great Linford

Offers Over £550,000 (Guide price £550,000 to £575,000)

 4  2  2



Located in the highly desirable and picturesque area of Great Linford, this beautifully presented four-bedroom detached family home with a double garage offers an exceptional standard of living and has been thoughtfully updated by the current owners over the past nine years.

REF:AJ1276

## Key Features

- 1980s built detached home
- Council tax band E
- 139m<sup>2</sup> = 1493 Sq Ft
- New boiler and central heating system (2023)
- Stylish ensuite and contemporary family bathroom
- Current owners since 2016
- Approx. monthly utility bills = £150pcm
- Vendors are re-locating
- Recently replaced double-glazed windows and doors
- REF: AJ1276

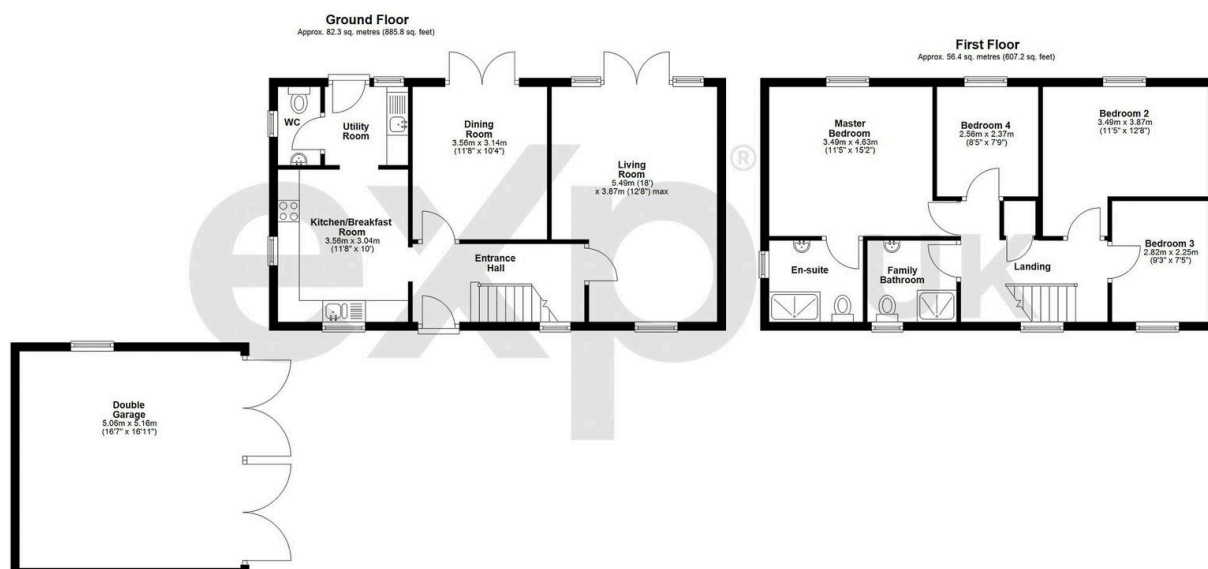

Total area: approx. 138.7 sq. metres (1493.0 sq. feet)