

Hilltop Road, Rochester, ME2 4QJ

£340,000

 3  1  2



Charming 3-Bedroom Home set back off the road with a lovely size front Garden in the popular Frindsbury! Welcome to Hilltop Rd, where this delightful 3-bedroom home combines space, style, and superb connectivity. Step inside, and you'll find a bright and airy through-lounge and dining room, perfect for relaxing in front of the Wood burner on those colder evenings and entertaining. The upstairs bathroom adds convenience, while the three separate bedrooms offer space for a growing family. Outside, the long front garden adds charm, and with two parking spaces, you'll never struggle to park. To the rear, the south-facing garden is a suntrap, ideal for summer evenings! Located in a highly sought-after area, you're just minutes from Strood Station, offering fast links to Ebbsfleet & St Pancras.



07778 703 438



phil.abrahart@exp.uk.com



philabrahart.exp.uk.com



Phil Abrahart is an approved agent of exp World UK Limited, trading as exp UK, registered at 5 Churchill Place, 10th Floor, London, United Kingdom, E14 5HU. Company number 12016573. VAT no 327 4120 29. If you have instructed another agent to sell your house and instruct exp World Ltd to sell your property at the same time, then you could be liable to pay both agents. It is recommended that you check the contract you have with your current agent.

PHIL ABRAHART

POWERED BY
exp UK

- 3 Separate bedroom House in a desirable road
- Through lounge and dining room perfect for entertaining
- Walk into Town or to the local Co-op and convenience stores
- 100 foot rear Garden great for children, pets and entertaining
- Long front Garden with Parking in front of that for 2 cars
- Walk to the Railway Station at Strood for High Speed links to Ebbsfleet & St Pancras
- South facing rear garden, great for you sun worshippers
- Nice size entrance hall for both coats and shoes and great welcome to the house
- Workshop in the garden to stay which has both power and light
- Quote PA1009 when calling in

Ground Floor

Approx. 32.1 sq. metres (345.6 sq. feet)

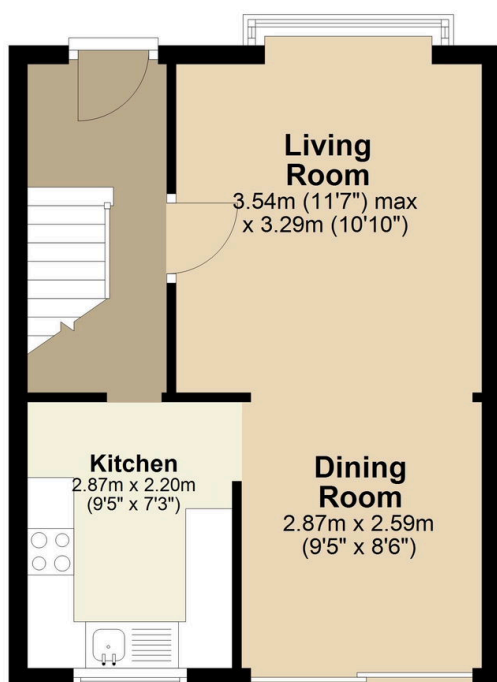

First Floor

Approx. 31.5 sq. metres (339.3 sq. feet)

