



JULES MIDDLETON

exp[®] UK

@ jules.middleton@exp.uk.com

🌐 julesmiddleton.exp.uk.com

☎ 07539 429 451

Elstree Road, Hemel Hempstead, HP2 7PH

£499,950

3 1 2



- Extended three bedroom family home in a quiet residential street.
- Separate ground floor office/ guest room.
- New bespoke bathroom
- Super fast Virgin Broadband available (subject to package).
- Walking distance to excellent schools
- Modern kitchen with filtered tap and water softener.
- Excellent decorative order.
- Private Garden.
- Off Street Parking and Garage.
- Please quote JM0792 when enquiring.



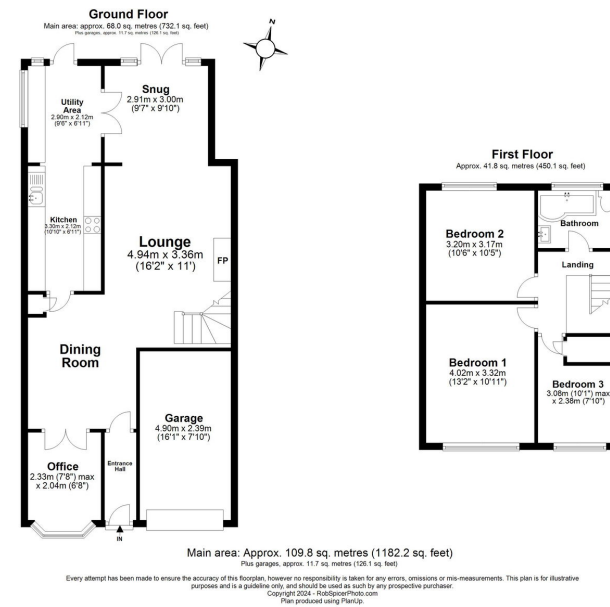

Extended to the front and rear , three bedroom semi-detached family home in a quiet residential street in the highly popular commuter town of Hemel Hempstead. Walking distance to excellent schools, amenities and fabulous walks.

